



Sales Brochure

Cabins

ENG



GROUP PROFILE

| | | | |
|---|--|---------------------------------------|-----------------------------------|
| INDUSTRIAL & BRAND STRUCTURES pag. 8 | MANUFACTURING & COMMERCIAL UNITS pag. 9 | OUR PRODUCT RANGE pag. 10 | OUR CABINS pag. 12 |
| PRODUCT DESCRIPTION pag. 16 | DESTINATIONS/ APPLICATIONS pag. 18 | TECHNICAL DATA pag. 20 | STEEL WORKS pag. 21 |
| PRODUCT DESCRIPTION pag. 24 | DESTINATIONS/ APPLICATIONS pag. 26 | TECHNICAL DRAWINGS pag. 32 | |
| PRODUCT DESCRIPTION pag. 34 | DESTINATIONS/ APPLICATIONS pag. 36 | TECHNICAL DRAWINGS pag. 42 | |
| PRODUCT DESCRIPTION pag. 44 | DESTINATIONS/ APPLICATIONS pag. 46 | TECHNICAL DRAWINGS pag. 52 | |
| PRODUCT DESCRIPTION pag. 54 | DESTINATIONS/ APPLICATIONS pag. 56 | PRODUCT CHARACTERISTICS pag. 58 | REFERENCES pag. 59 |
| INTRODUCTION pag. 60 | WALLS pag. 62 | FLOOR pag. 65 | CIELING & LIGHTINGS pag. 66 |

| | | | |
|--|-------------------------|-------------------------------------|-------------------------------|
| PRODUCT SELECTION GUIDE pag. 13 | GOING GREEN! pag. 14 | | |
| TECHNICAL DRAWINGS pag. 22 | | | |
| | | | |
| | | | |
| | | | |
| | | | |
| HANDRAILS & SKIRTINGS pag. 68 | BUMPERS pag. 70 | MIRRORS & ACCESSORIES pag. 71 | SELECTION GUIDE pag. 72 |



INTRODUCTION

EASY

VARIO

ADAPTA

CARGO

CUSTOM

FINISHES



GROUP PROFILE

Moving Vertically

INTRODUCTION



GROUP INDUSTRIAL STRUCTURE

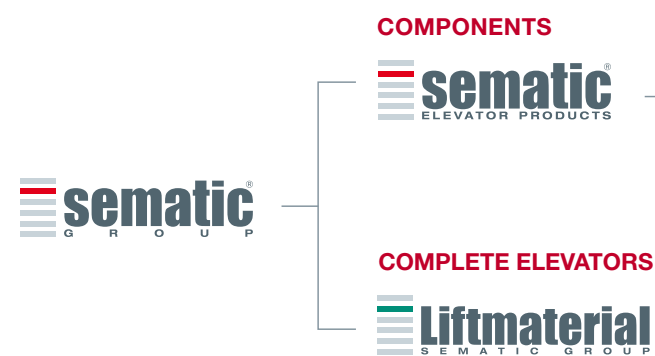

PRODUCT BRANDS



MANUFACTURING UNITS & COMMERCIAL OFFICES

AMERICA

USA

Tyler Elevator Products
a division of Sematic USA, Inc

Mexico

Sematic Elevadores Mexico

EUROPE

Italy

Sematic spa
Computec srl

United Kingdom

Sematic UK Ltd

Germany

LM Liftmaterial GmbH

Hungary

Sematic Hungária kft

Turkey

Sematic Asansör San.ve Tic.Ltd.Sti.

ASIA

China

Sematic Elevator Products
(Suzhou) Co., Ltd
Sematic Elevator Products
(Changshu) Co.,Ltd.
Sematic Hong Kong Ltd

Singapore

Sematic Singapore Pte Ltd

India

Sematic RE Elevator
Products (India) Pvt Ltd



COMPLETE ELEVATORS

- Rope traction elevators with the drive unit available in various machines room locations
- Machine room-less rope elevators
- Modular hydraulic elevators with cantilevered car sling
- Hydraulic elevators with cylinder under or beside the car, twin piston or pulling piston drive system
- Panoramic elevators
- Hospital elevators
- Special executions



AUTOMATIC LIFT DOORS

- Standard and special car and landing doors
- Full glass and framed glass doors
- Doors for panoramic and high rise elevators
- Doors for goods and industrial lifts, doors for marine applications
- Round doors and doors for inclined elevators
- Doors able to withstand saline, dusty atmospheres, extreme weather conditions, high humidity and rain
- Doors for modernization
- Fire rated doors, vandal-resistant doors and doors with smoke seal execution
- Doors with hidden bottom track and with under-driven operator



LIFT CABINS

- Standard and special cabins
- Goods-lift cabins, cabins for ships, panoramic cabins, hospital lift cabins
- Water tight cabins, round cabins
- Cabins with bullet-proof glass and vandal-resistant cabins
- Cabins with under-driven operator, cabins with integrated frames
- Hydraulic and traction car frames



ENTRANCES

- Program entrances
- Custom entrances
- Home lifts complete car door systems
- Standard and special car and landing doors
- Complete car door systems
- Standard and special cabins





Always the right solution

The solutions offered by our cabins resolve a myriad of installation problems in terms of space and utilization, from residential and small-scale commercial properties to large-scale, complex environments.



Tradition + Innovation

Our cabin range offers a wealth of options, ranging from the more traditional to the most technologically advanced, such as circular cabins and angled installations.



Experts in complex projects

The technology used for high-rise and heavy-duty solutions makes the most of the Group's consolidated experience. Verri has what it takes to satisfy the superior performance levels demanded by these applications.



Kings of customization

Materials and finishes of our cabins can be infinitely customized to suit your own requirements. Special solutions are no exception, from glass to non-standard structures.



The pursuit of excellence

Verri has always pursued excellence: both in terms of technology, with cabins that can be integrated into the most cutting-edge projects, and in terms of design, with an all- Italian commitment to getting the details and the styling just right.



A perfect integration

The possibility to combine the technology and the style of Verri cabins together with Sematic Lift Doors ones guarantees high-quality installation solutions that deliver superior reliability.

| APPLICATIONS | DESTINATION | | | | | |
|------------------|-----------------------------------|---------------------|---------------------|---------------|--------------------|-----------------------------|
| | PASSENGERS | | GOODS | | SPECIAL USES | |
| | DOORS | CARS | DOORS | CARS | DOORS | CARS |
| HOMELIFT | 2000 T | ADAPTA VARIO | | | | |
| RESIDENTIAL | 2000 B 2000 C 2000 B-HR LOW | ADAPTA | 2000 B-G | CARGO | 2000 SWS | CUSTOM |
| OFFICES | 2000 B 2000 C 2000 B-HR LOW | ADAPTA | 2000 B-G | CARGO | 2000 SWS 2000 R | CUSTOM PANOR./CUSTOM |
| HIGH RISE | 2000 B-HR MED 2000 B-HR TOP | VARIO | 2000 B-G | CARGO | 2000 HD | CARGO |
| HOSPITALS | 2000 B 2000 B-HR LOW | VARIO | 2000 B-G | ADAPTA | 2000 B-G | ADAPTA |
| TRANSPORT | 2000 B 2000 B-HR LOW | ADAPTA | 2000 HD 2000 B-G | CARGO | 2000 SWS | CUSTOM |
| MODERNIZATION | 2000 T 2000 C-MOD | EASY ADAPTA | 2000 B-G | CARGO | 2000 HD | CARGO |
| HOTELS | 2000 B 2000 B-HR LOW | VARIO | 2000 B-G | ADAPTA | 2000 R | PANORAMIC CUSTOM |
| SHOPPING CENTERS | 2000 B 2000 B-HR LOW | ADAPTA | 2000 B-G | ADAPTA | 2000 HD 2000 R | CARGO PANOR./CUSTOM |
| INDUSTRIAL | | | 2000 B-G | CARGO | 2000 HD | CUSTOM CARGO |

GOING GREEN!

Sematic for Energy Saving

Door Drive Controller

Sematic SDS & SRS controllers featuring parking mode save up to **63%**

Cabin lights

Lighting systems for cabs that can save up to **3 times** the required energy

Cabin appliances
air conditioning, displays, etc.

CLASS A cabin appliances (fans, air conditioning) to reduce at minimum the energy spent

Energy efficiency offers a powerful tool for achieving a sustainable energy future

Improvements in energy efficiency can cut costs, increase competitiveness and improve customer welfare

At Sematic, we take our energy use seriously and, during our 50 years of history, we have designed and developed a set of technological devices and tips that allow our elevator components to use as little energy as possible and that can help in lowering the significant amount of energy spent in buildings

$$2 + 2 = 7$$

EASY

The right solution for modernizations

Lightness, flexibility, reliability, comfort, modern design. Those are just few words that describes Easy, the perfect solution for modernization projects, fully compliant to EN 81 standards

Easy is not just a cabin, it's a complete car and sling package that perfectly integrates into small shafts. The peculiarity of this solution is that the distance between guides is just 30-40mm (depending on the cladding) more than the car width

This allows compact overall dimensions and therefore more space inside the cabin compared to the standard solutions

Light, reliable and flexible, this product has no welded part. It is easy and quick to mount and last but not least, ideal for logistics



EASY

Application: Modernization
Wall: Skinplate, Mirror
Floor: PVC
Ceiling type: Suspended
Handrails: Aluminum

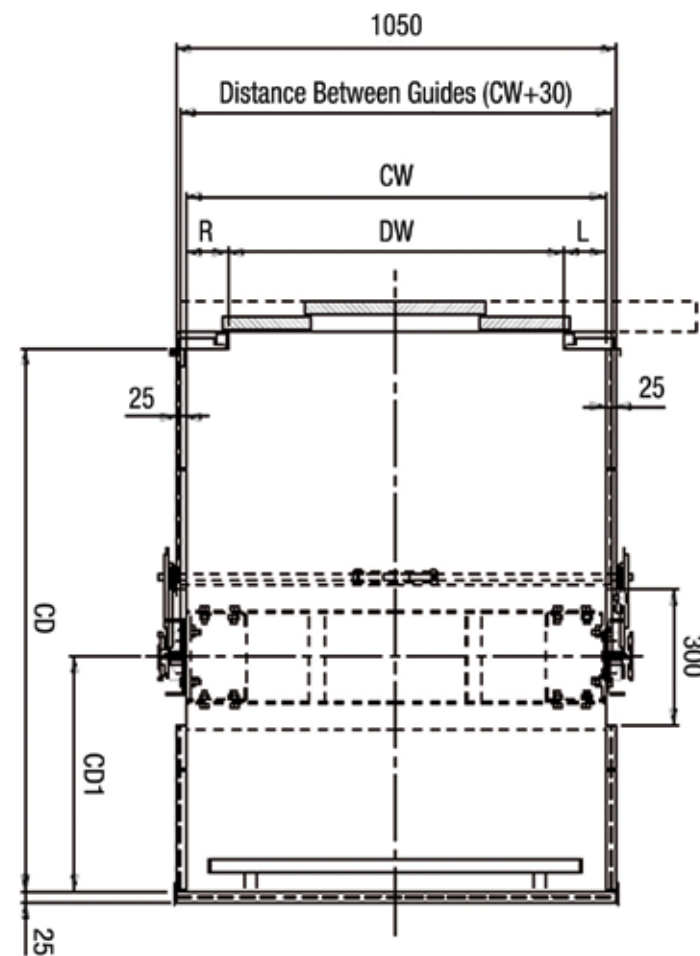
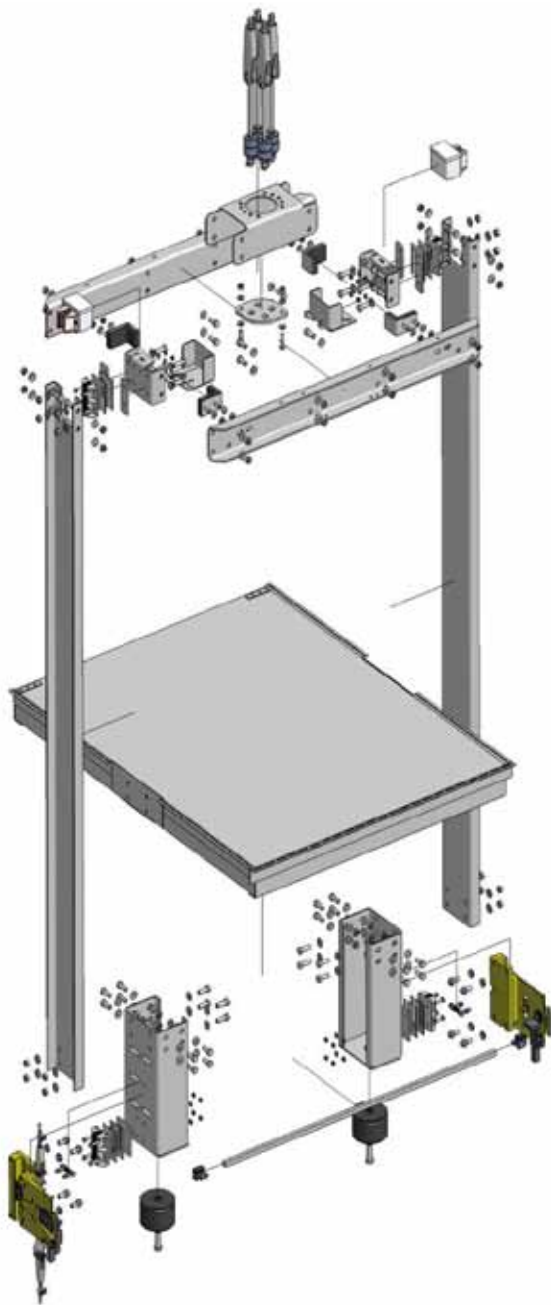

RELIABILITY

Cabin components are designed and manufactured in order to guarantee high performance and easy installation

- Metal sheet structure for light weight
- Only few components almost integrated in car platform
- Ropes or belts fixing
- Compact safety gear application
- No welded part
- Self-bearing car platform

FLEXIBILITY

Distance Between Guides = Car Width + 30mm for self-bearing cars, 40mm for plastic laminate claddings

- CW = Car Width
- CD = Car Depth
- CD1 = distance between rear wall and sling center
- DWG = Distance Between Guides
- DW = Door Width



Manufacturing of elevator structural parts

Verri offers a complete service concerning steelworks starting from analysis, check and realization of frames, counterweights, beams, brackets and other lift structural components. The achieved experience allows us to realize simple hydraulic lifts up to big ones for 20 Tons 6:1 lifts.

The structural calculation and simulation (FEM) of car sling parts checked with a dimensional test, is getting more and more important, in order to offer the best solutions in terms

of weight, shape and performance.

Our solutions are suitable for a complete range of capacities, speeds and applications: instantaneous and progressive safeties; gear raft and complete tailored solutions; complete range of "L" frames and hydraulic slings, including head pulleys and counterweight arrangements; complete range of car slings for traction elevators, including counterweight arrangements and underslung application.

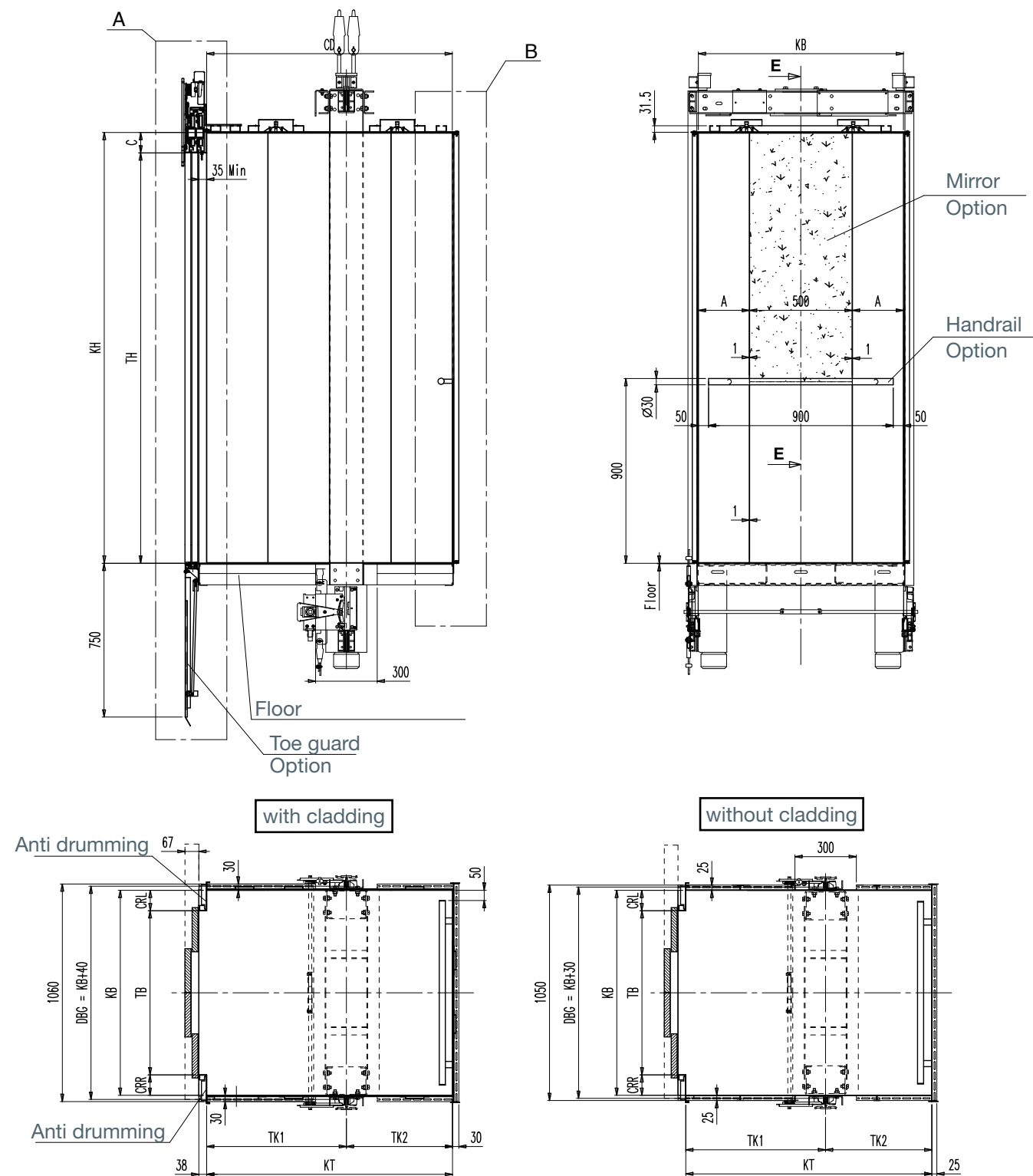

DOORS SUGGESTED FOR THIS CABIN

> 2000 C-MOD > 2000 T

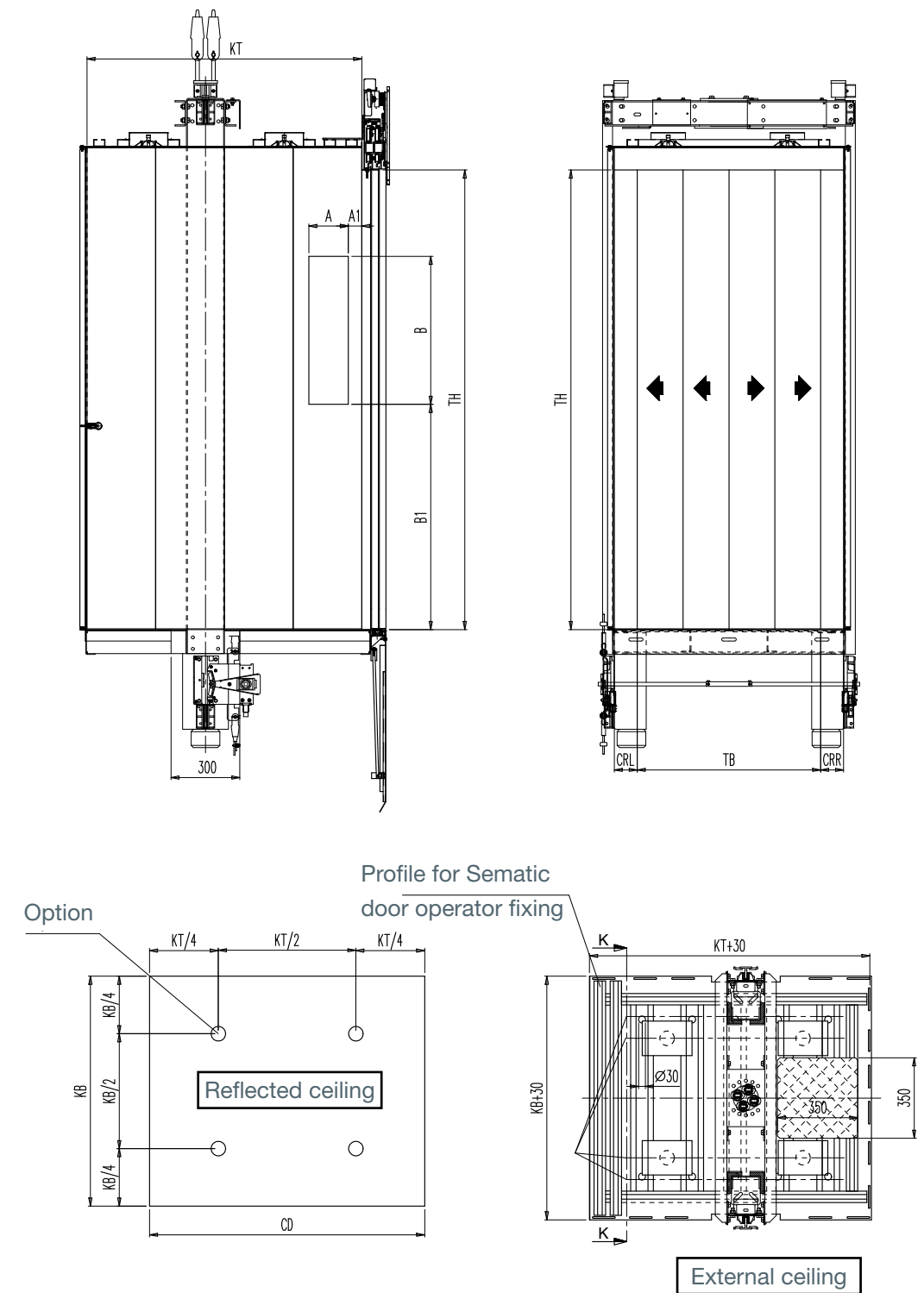

VARIO

Any kind of finishes on a strong wall structure

The Vario product line has been designed to offer a wide range of finishes, on a strong steel wall structure

It's the ideal solution for top design projects, such as high rise buildings and hotels, as it combines very good resistance with a wide choice of prestigious interior materials including marble, veneered wood and colored glass walls as well as composite stone floors

The product line is completed by a series of optional extras (fans, air conditioning, anti-drumming system, special ceilings and lightings) that contribute to increasing the overall comfort and to improving the passengers' experience, but always keeping an eye on energy waste

In our research for innovation we choose to offer such devices in "class A" so that they can guarantee the best efficiencies in terms of performances and energy saving





VARIO

Application: Residential
Wall: Plastic Laminate, Mirror
Floor: Wood
Ceiling type: Glass
Handrails: Stainless Steel
Skirtings: Stainless Steel

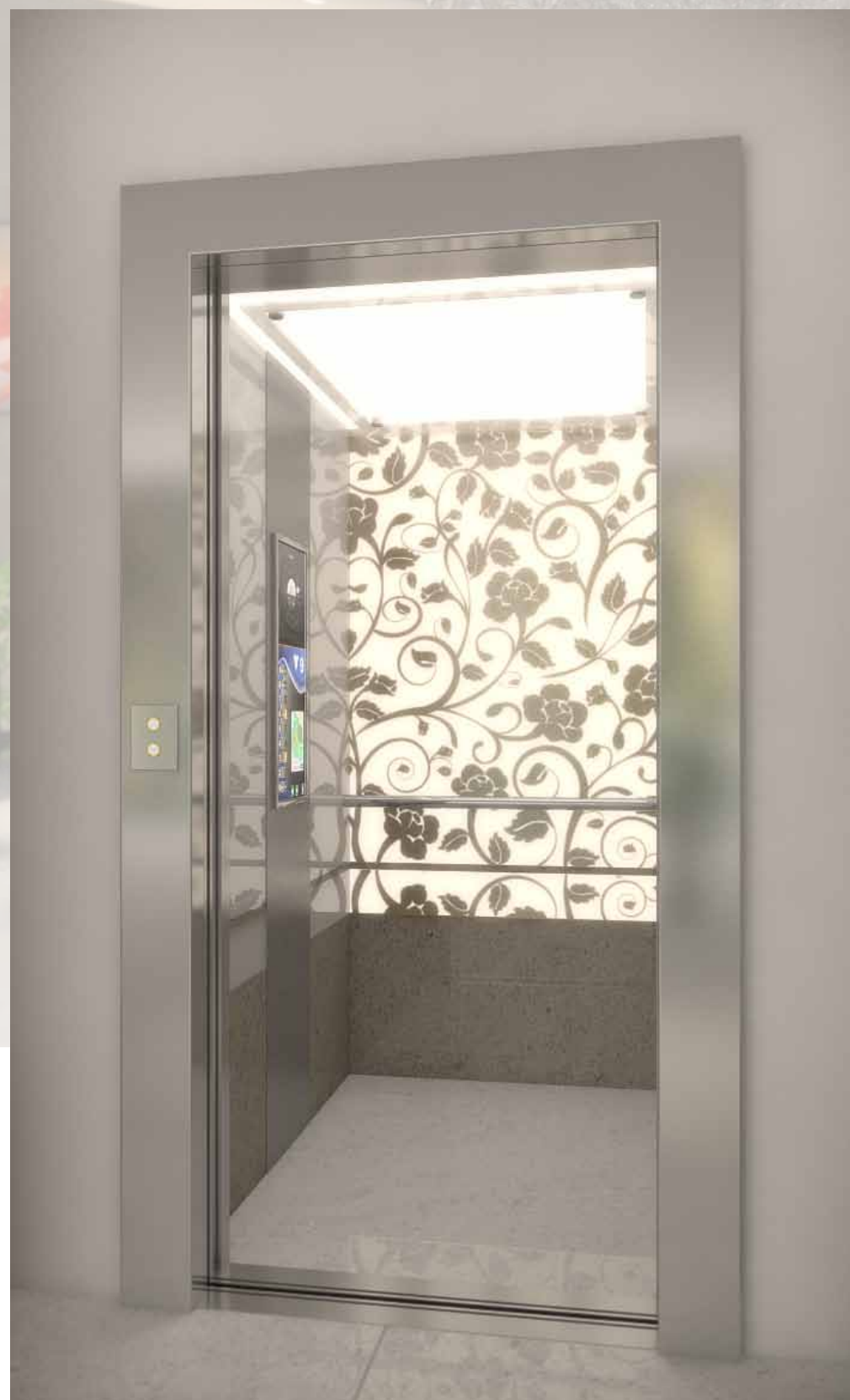

VARIO

Application: Hotels
Wall: Marble, Stainless Steel
Floor: Marble
Ceiling type: Glass
Handrails: Stainless Steel

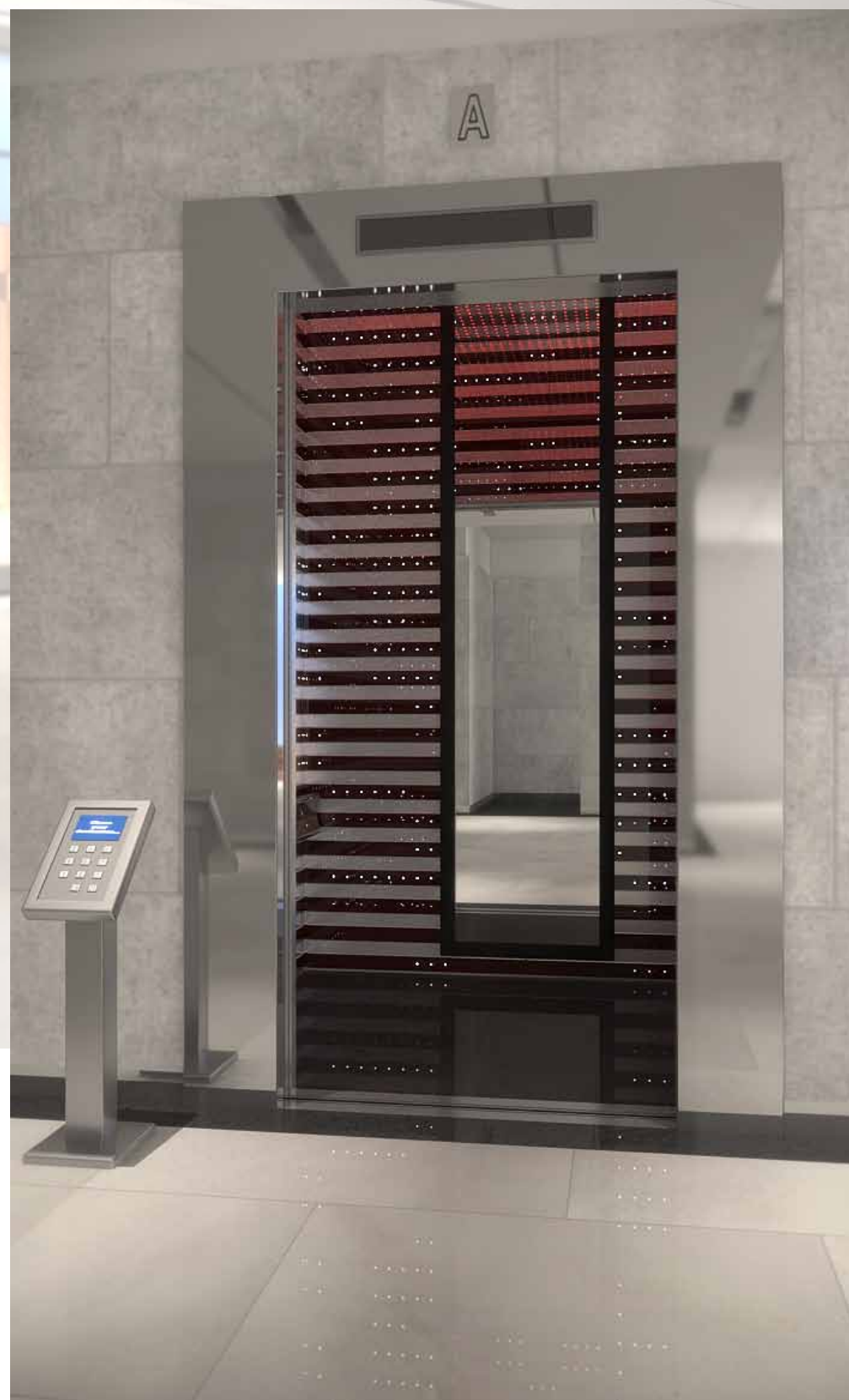

VARIO

Application: High-Rise
Wall: Stainless steel, Mirror
Floor: Composite stone
Ceiling type: Glass with leds

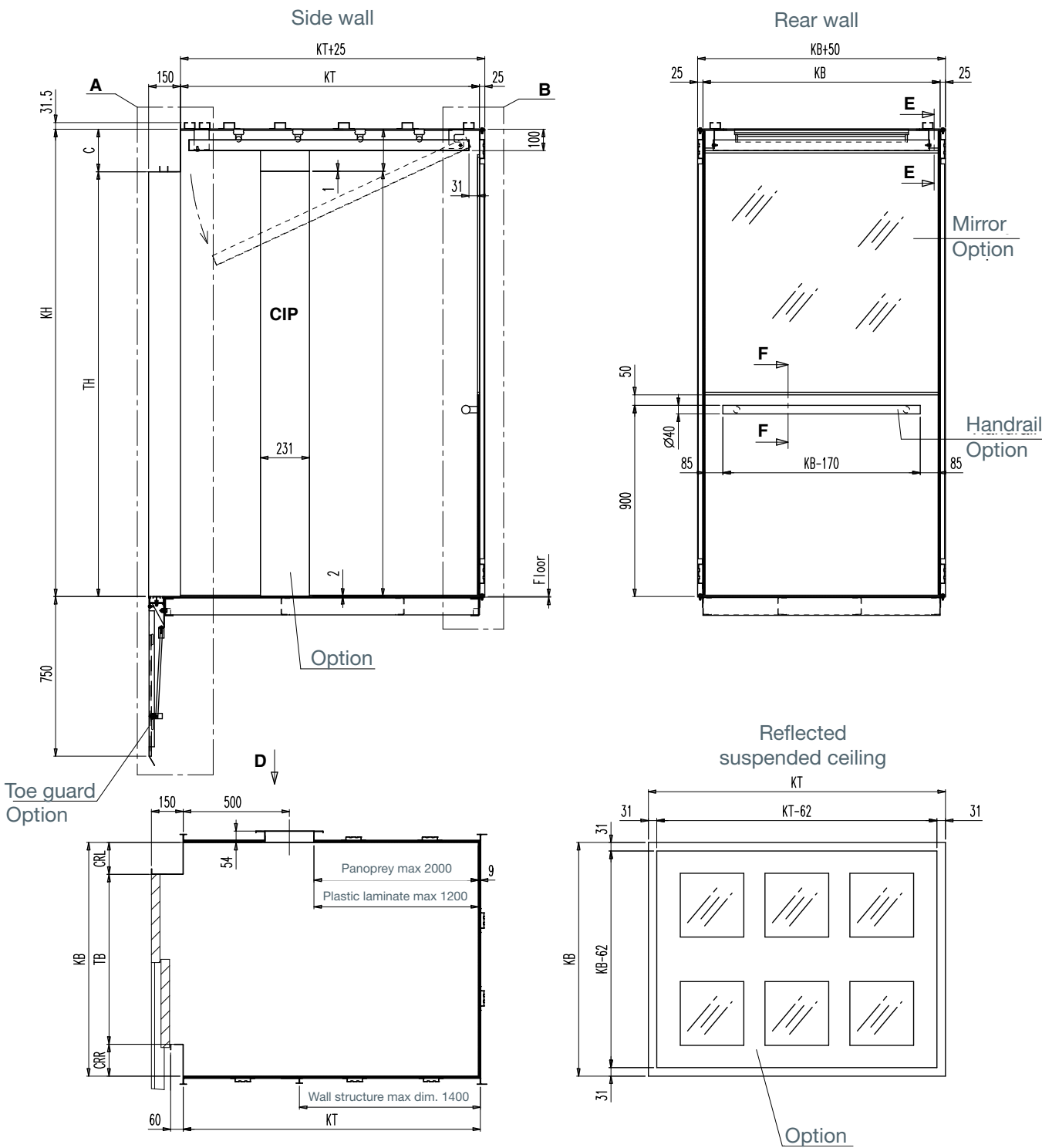

DOORS SUGGESTED FOR THIS CABIN
> 2000 B > 2000 B-HR

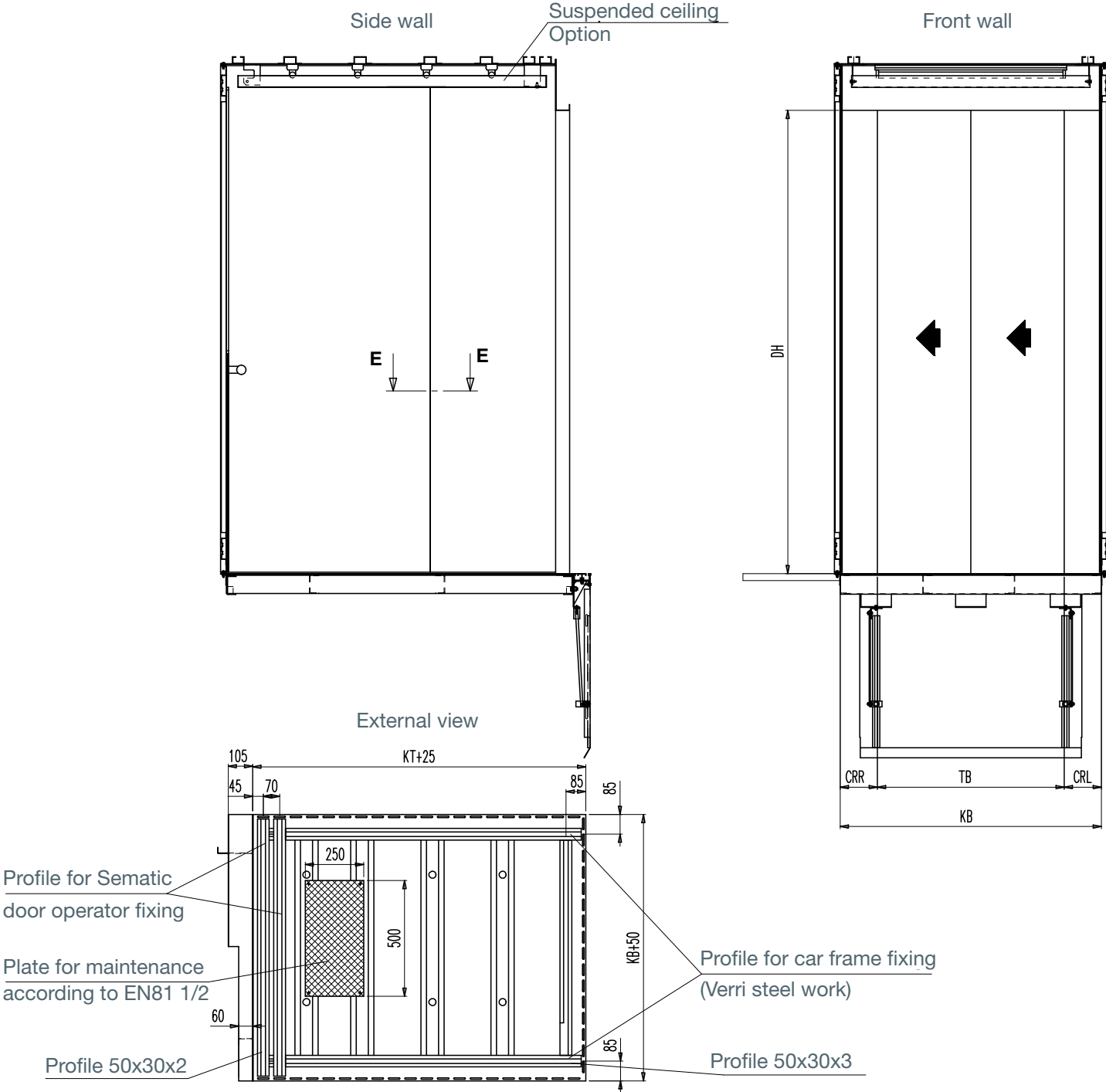

| Load Kg | 320 | 450 | 480 | 480 | 630 | 800 | 1000 | 1050 | 1000 | 1250 | 1600 |
|---------|------|------|------|------|------|------|------|------|------|------|------|
| KB | 900 | 1200 | 950 | 1350 | 1100 | 1400 | 1000 | 1100 | 1600 | 1200 | 1400 |
| KT | 1000 | 1000 | 1300 | 950 | 1400 | 1400 | 2100 | 2100 | 1400 | 2300 | 2400 |
| KH | 2200 | 2200 | 2200 | 2200 | 2200 | 2200 | 2200 | 2200 | 2200 | 2200 | 2200 |
| G | 87 | 87 | 87 | 87 | 87 | 87 | 87 | 87 | 87 | 83 | 83 |

ADAPTA

High flexibility and precision mounting cabin walls

Adapta offers high flexibility, precision mounting of the self-bearing walls and an excellent range of standard finishes

It's a cabin suitable for a wide range of applications, from residential and office buildings, to airports, train and underground stations, shopping centers, hotels and hospitals, as it can be used both for goods and passenger transport

Adapta's range of finishes includes skinplate, stainless and painted steel walls, PVC, metal and composite stone floors and a complete set of ceilings, skirtings, handrails, bumper rails, mirrors and ceilings in all of today's available materials, making this product line perfect for the integration also into the most ambitious architectural projects





ADAPTA

Application: Offices
Wall: Painted Steel, Mirror
Floor: PVC
Ceiling type: Suspended
Handrails: Stainless Steel
Skirtings: Stainless Steel



ADAPTA

Application: Hospitals
Wall: Skinplate
Floor: PVC
Ceiling type: Suspended
Handrails: Stainless Steel
Skirtings: Stainless Steel
Bumpers: Stainless Steel

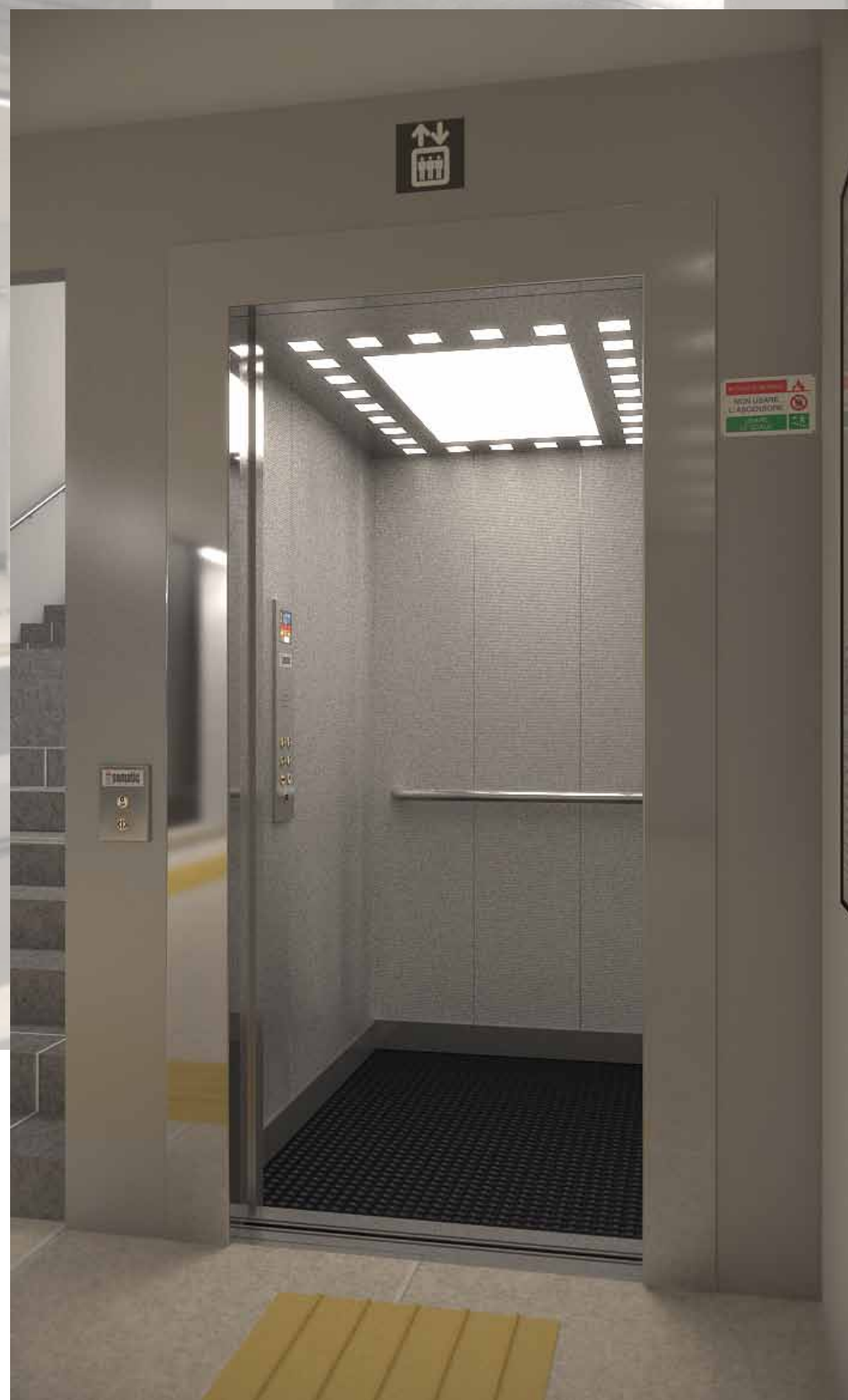

ADAPTA

Application: Transport
Wall: Stainless Steel
Floor: PVC
Ceiling type: Suspended
Handrails: Aluminium
Skirtings: Stainless Steel

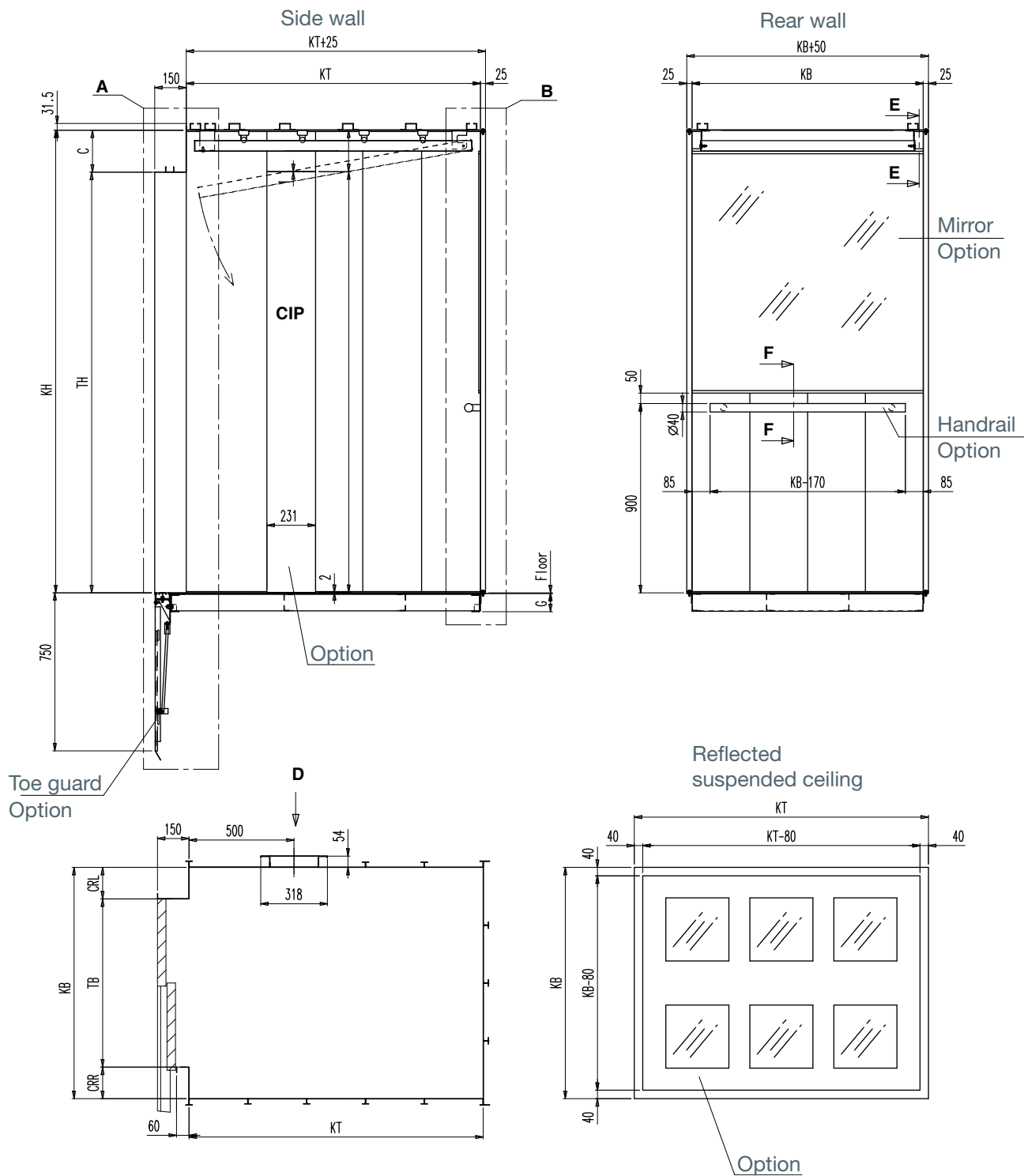

DOORS SUGGESTED FOR THIS CABIN

> 2000 B > 2000 C > 2000 B-G

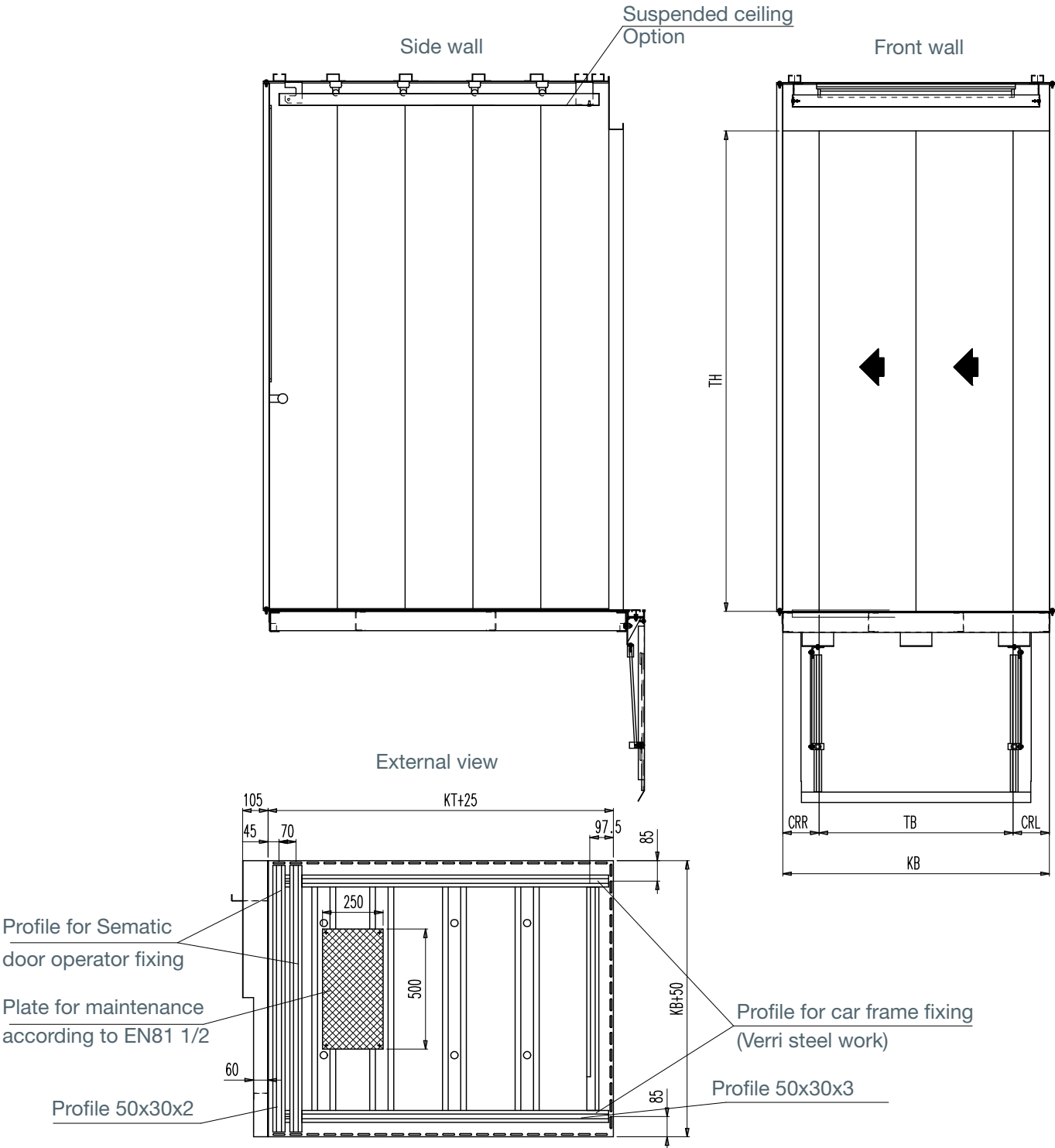

| Load Kg | 320 | 450 | 480 | 480 | 630 | 800 | 1000 | 1050 | 1000 | 1250 | 1600 |
|---------|------|------|------|------|------|------|------|------|------|------|------|
| KB | 900 | 1200 | 950 | 1350 | 1100 | 1400 | 1100 | 1100 | 1600 | 1200 | 1400 |
| KT | 1000 | 1000 | 1300 | 950 | 1400 | 1400 | 2100 | 2100 | 1400 | 2300 | 2400 |
| KH | 2200 | 2200 | 2200 | 2200 | 2200 | 2200 | 2200 | 2200 | 2200 | 2200 | 2200 |
| G | 87 | 87 | 87 | 87 | 87 | 87 | 87 | 87 | 87 | 83 | 83 |



CARGO

Heavy duty, heavy load cabin

Cargo is the cabin specifically studied for goods transportation and for all those situations where robust construction and resistant materials are a must. All of its components are designed with special care to quality and durability in order to guarantee high performances in time

Ideal for heavy-load lifts in factories and warehouses as well as for car and service lifts in airports, undergrounds, railway stations, shopping centers, multi-floor parking and hospitals, Cargo offers an ultra-strong structure to withstand also extreme use conditions, always without compromising aesthetics

A wide range of finishes and materials are available for the most demanding projects, including a complete set of bumper rails in wood, PVC, aluminum and stainless steel able to guarantee superior resistance to hits

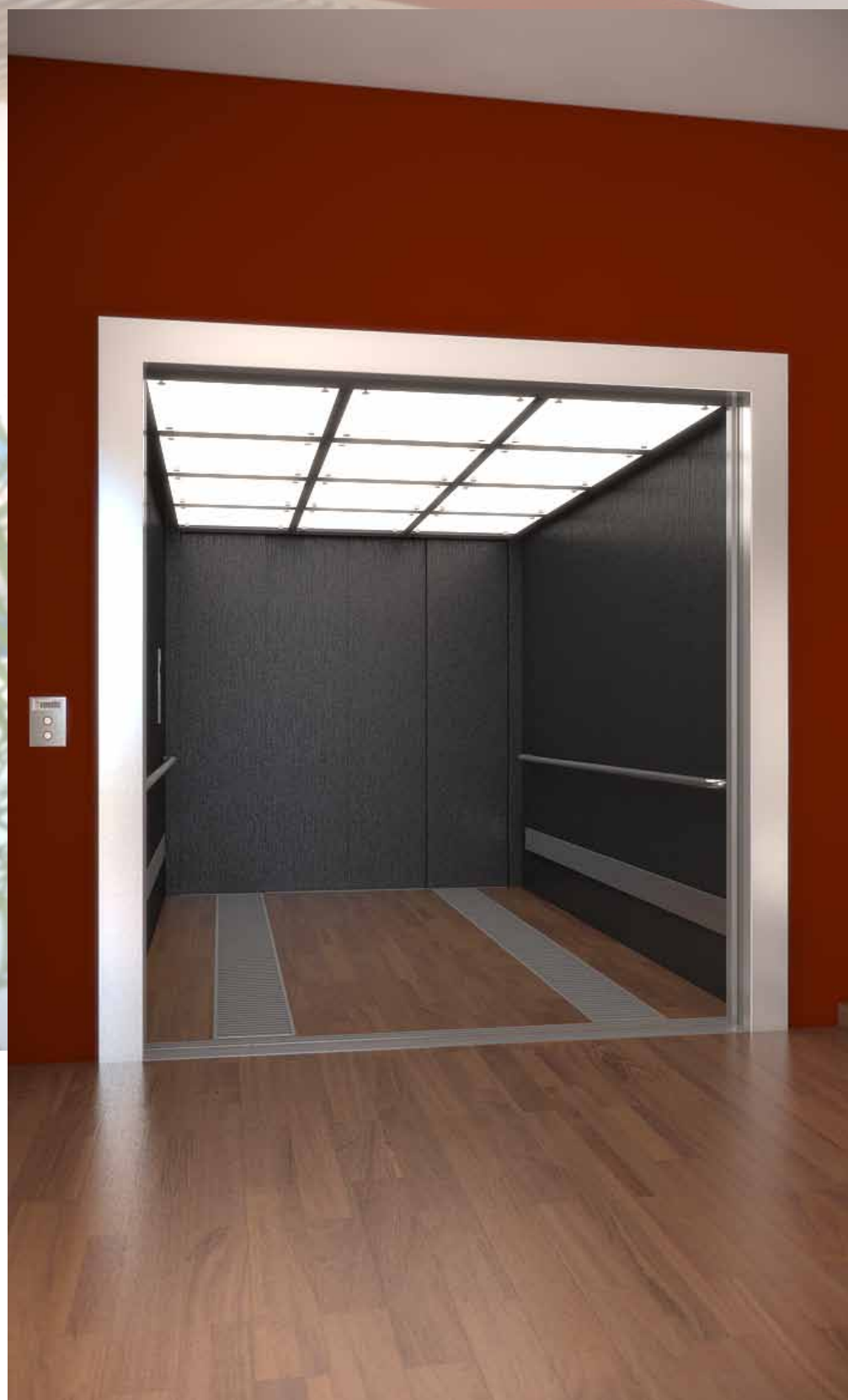

CARGO

Application: Residential
Wall: Stainless Steel
Floor: Wood, Metal
Ceiling type: Glass
Handrails: Stainless Steel
Bumpers: Stainless Steel

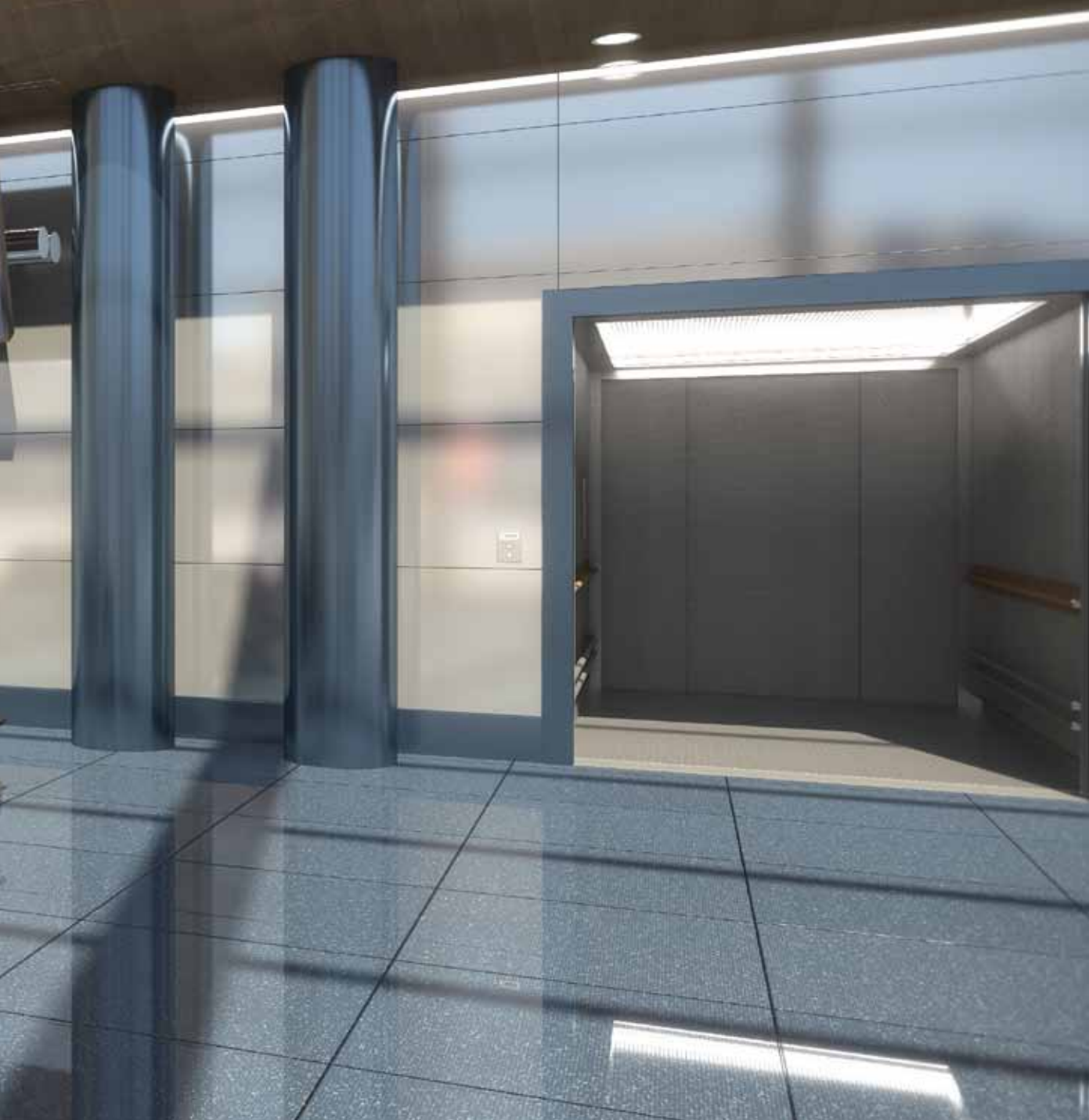

CARGO

Application: Transport
Wall: Stainless Steel
Floor: Metal
Ceiling type: Suspended
Handrails: Wood
Bumpers: Stainless steel
Skirtings: Stainless steel



CARGO

Application: Industrial
Wall: Skinplate
Floor: Metal
Ceiling type: Suspended
Bumpers: Wood

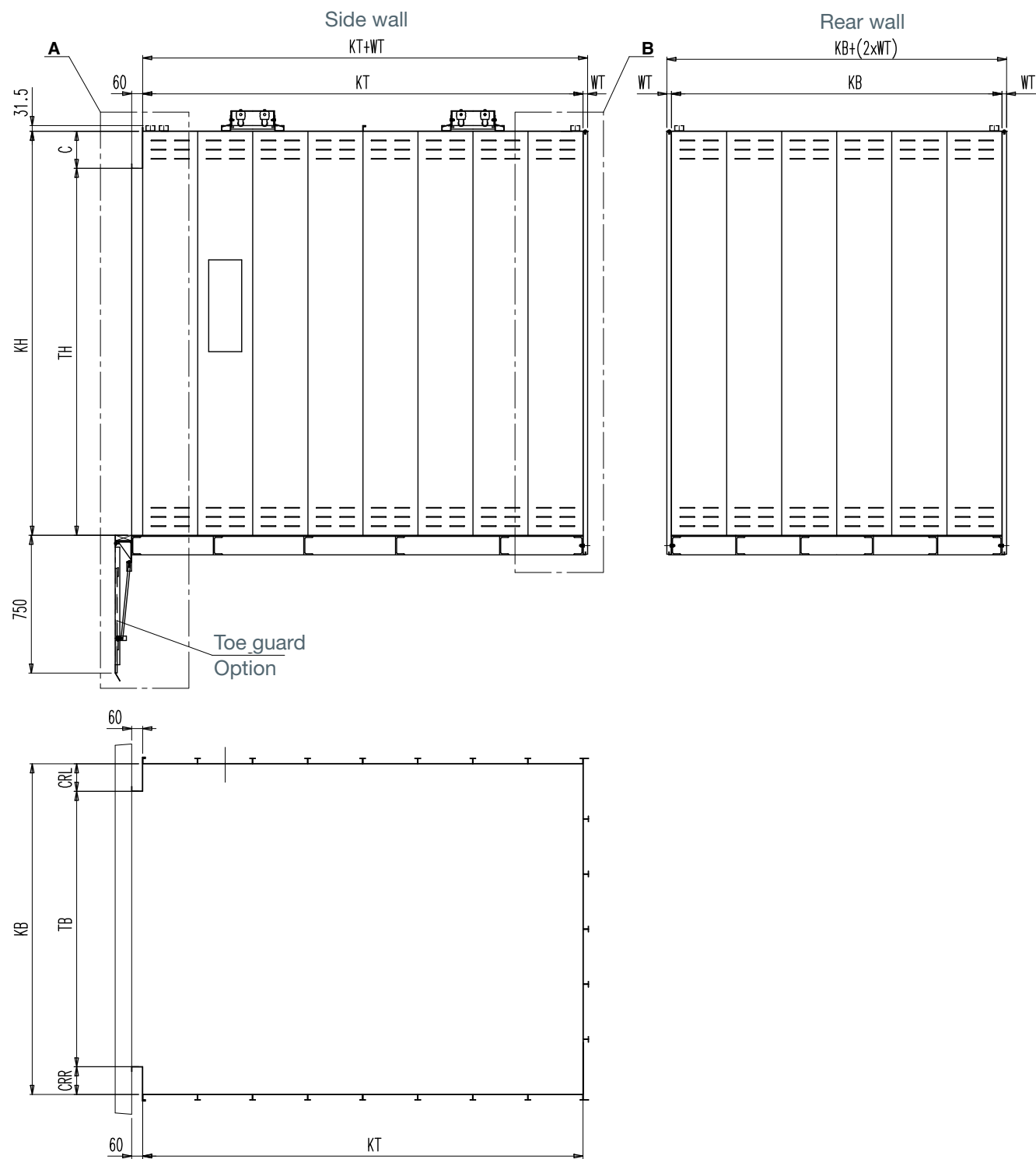

DOORS SUGGESTED FOR THIS CABIN

> 2000 B-G > 2000 HD

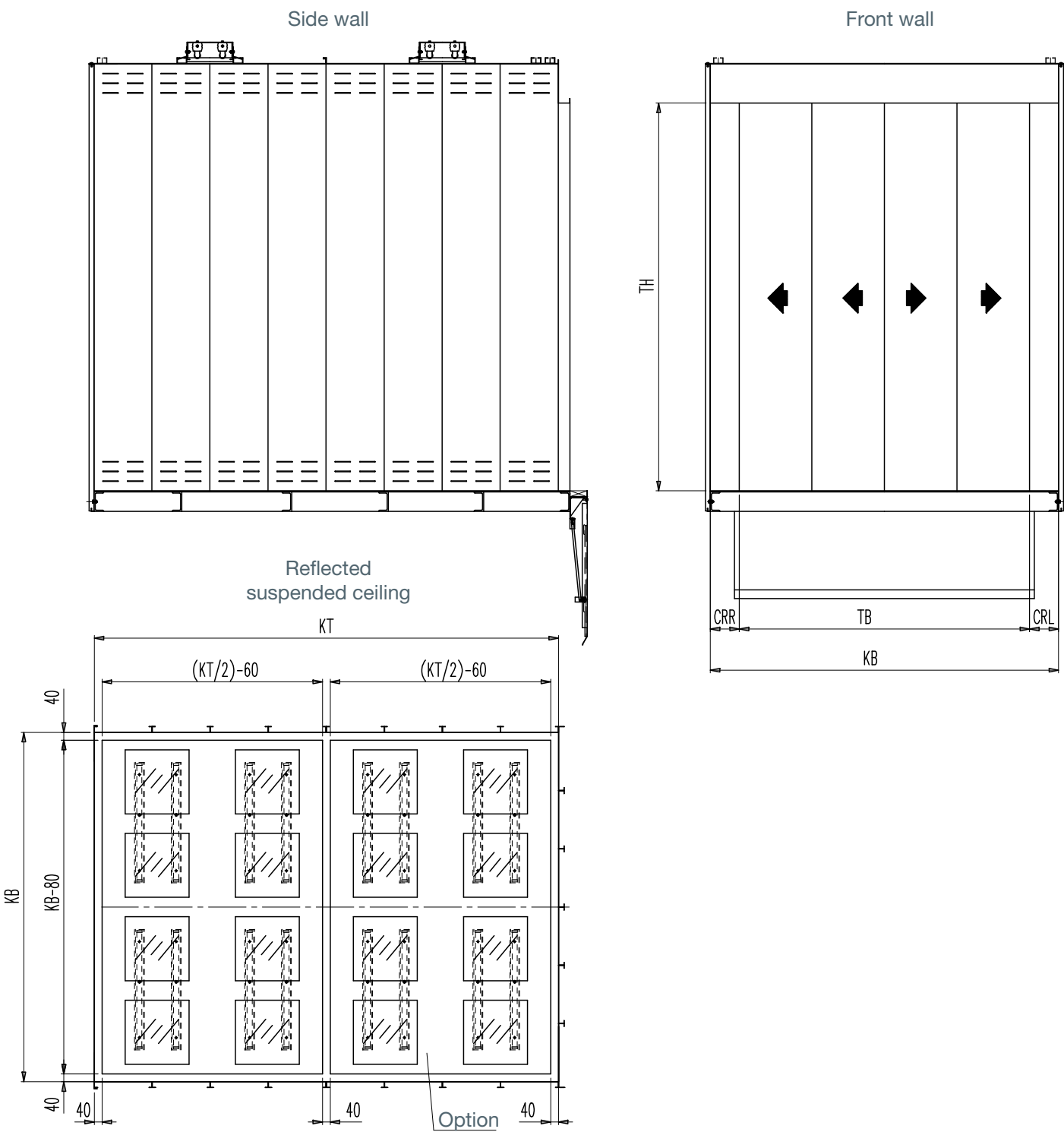

| Load Kg | 2000 | 2500 | 3200 | 4000 | 5000 |
|---------|------|------|------|------|------|
| KB | 1500 | 1800 | 2200 | 2200 | 2500 |
| KT | 2700 | 2700 | 2700 | 3200 | 3500 |
| KH | 2500 | 2500 | 2500 | 2500 | 2200 |
| G | 80 | 100 | 100 | 120 | 140 |



PANORAMIC/CUSTOM

From desire to design

Custom cabins are one-of-a-kind solutions that make your ideas real. Thanks to our long experience and expertise in cabin manufacturing we help you find the best solutions, in terms of choice of materials, finishes and optional extras, to realize your projects, understanding what is need to be done in order to make your cabin unique

We use a wide range of materials, from plastic laminate and marble to coloured glasses and composite stones, able to satisfy your every special need and thanks to our production processes and manufacturing technologies, we can offer you cutting edge products with the best possible quality

Furthermore we can provide cabins designed according to the most important international standards including, for example, special solutions for different applications that satisfy even the most demanding testing requirements



PANORAMIC

Application: Shopping Centre
Wall: Framed glass
Floor: Metal
Ceiling type: Suspended
Handrails: Stainless Steel
Skirtings: Stainless Steel

CUSTOM

From desire to design

CARE FOR DESIGN AND DETAILS

All the smallest details of Verri custom cabins are studied and designed with special care, leaving nothing to chance from a technical, functional and aesthetic viewpoint.

- Top design solutions
- Special wall / floor finishes
- Wide range of accessories and optional extras
- Glass panels and finishes
- Special cabin shapes

JOINT PROJECT DEVELOPMENT

We provide you with high-quality consultancy services from the planning stage to the final delivery, developing your cabin, according to your specs and together with you.

- Project planning
- Choice of materials and accessories
- Installation phase
- Final delivery



DOORS SUGGESTED FOR THIS CABIN

> 2000 R > 2000 B-HR > 2000 SWS

CUSTOM

Panoramic cabins

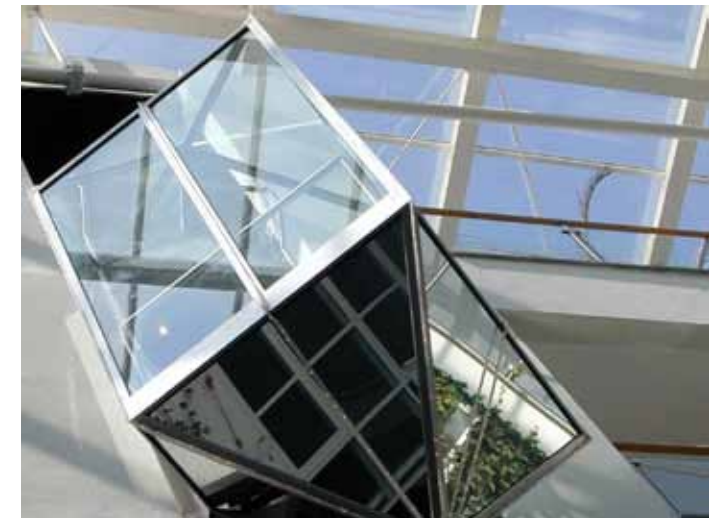

FINISHES & ACCESSORIES

Everything you need



SKINPLATE

Available for: EASY - ADAPTA - CARGO

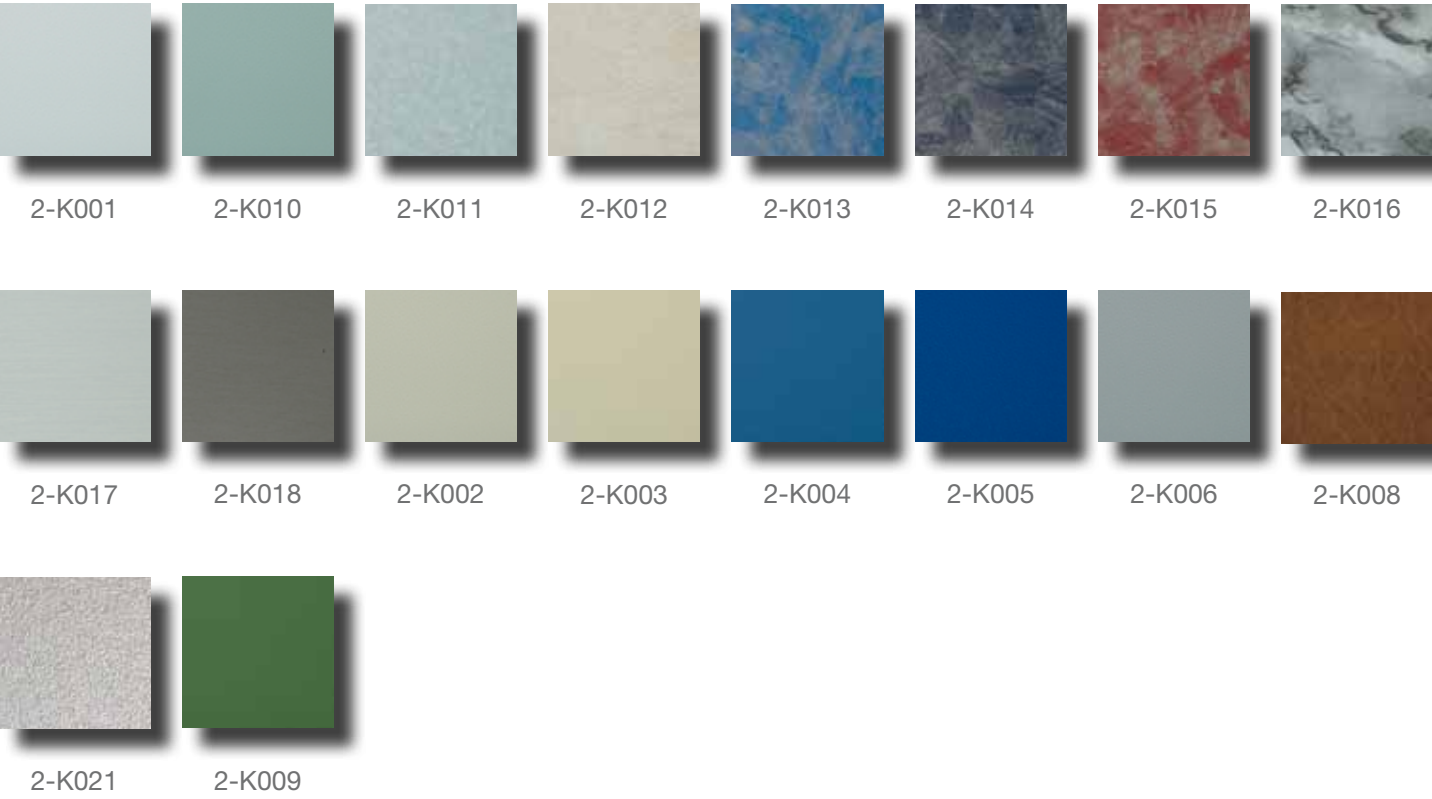

PANOPREY

Available for: EASY - VARIO

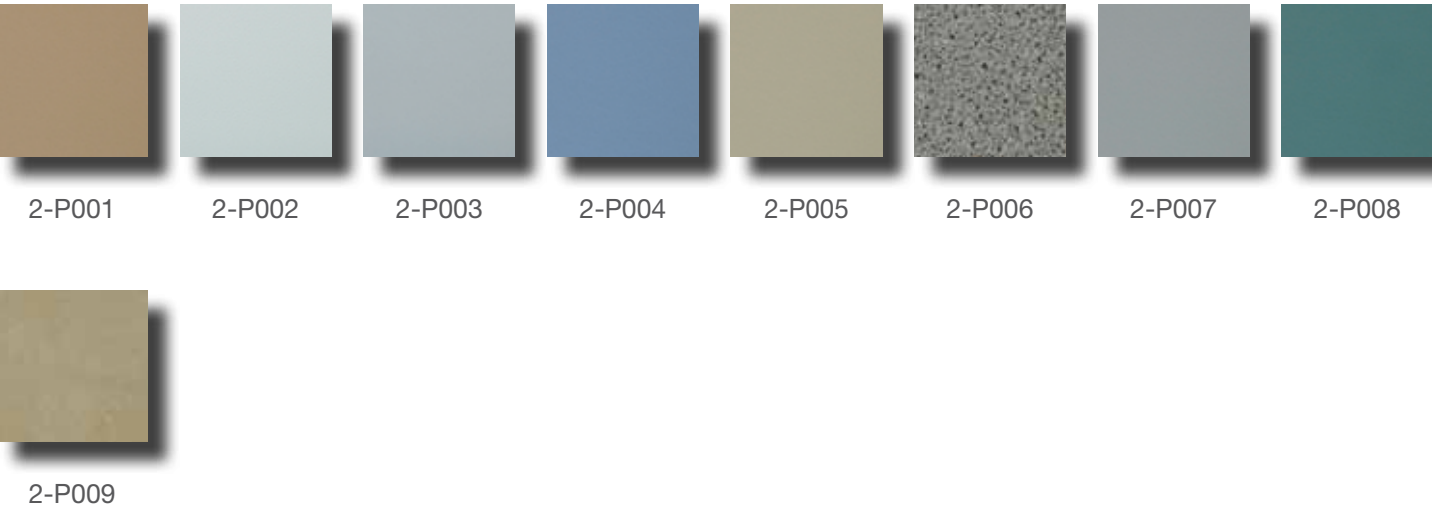

STAINLESS STEEL

Available for: EASY - ADAPTA - CARGO - VARIO

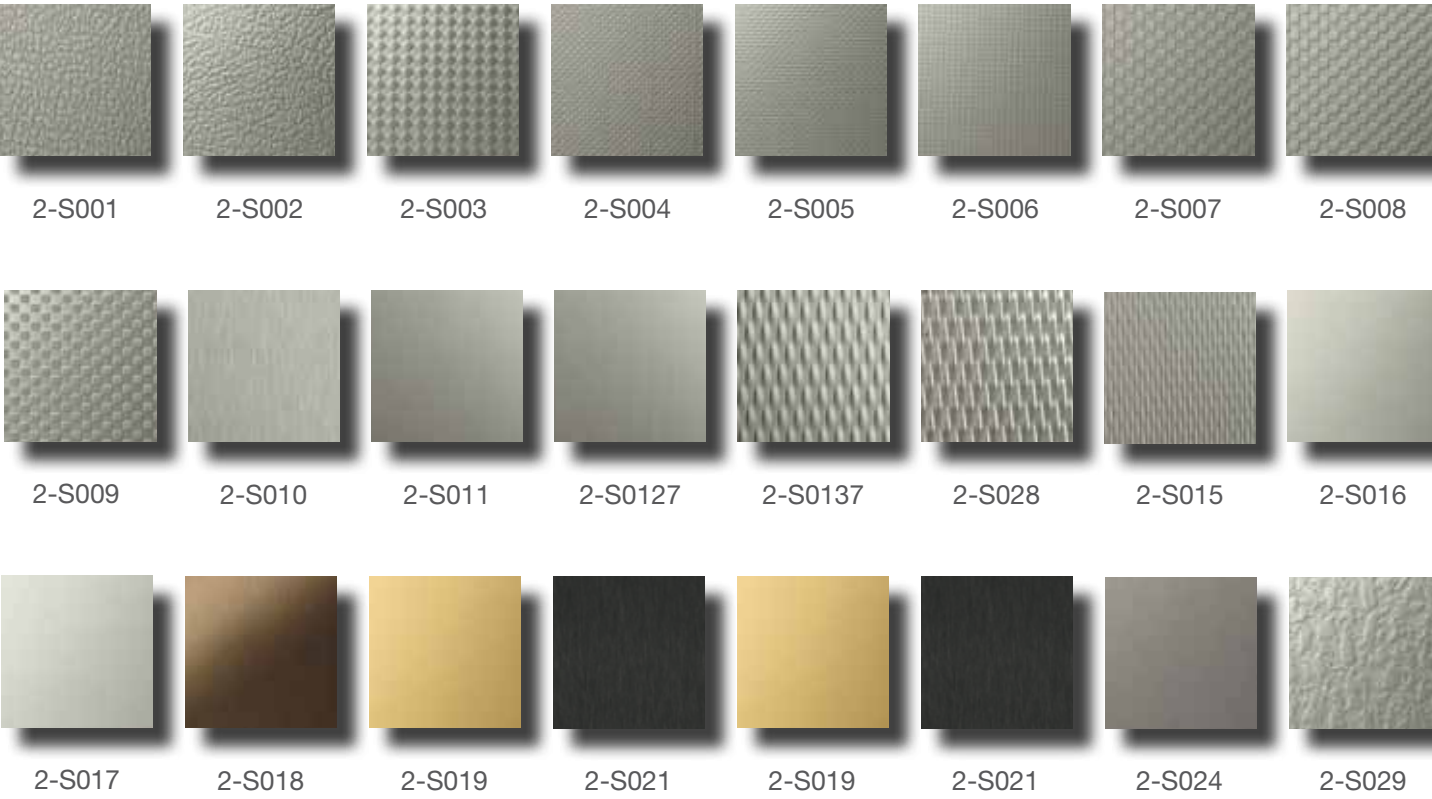

PAINTED STEEL

Available for: EASY - CARGO - ADAPTA

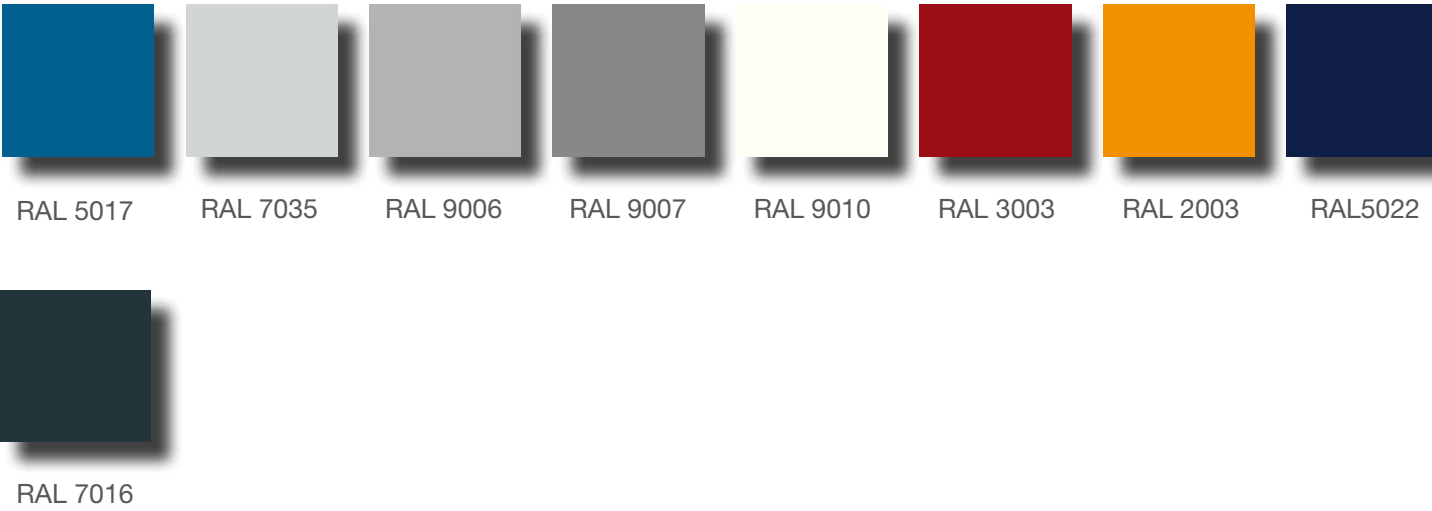

FINISHES

Walls

PLASTIC LAMINATE

Available for: EASY - VARIO

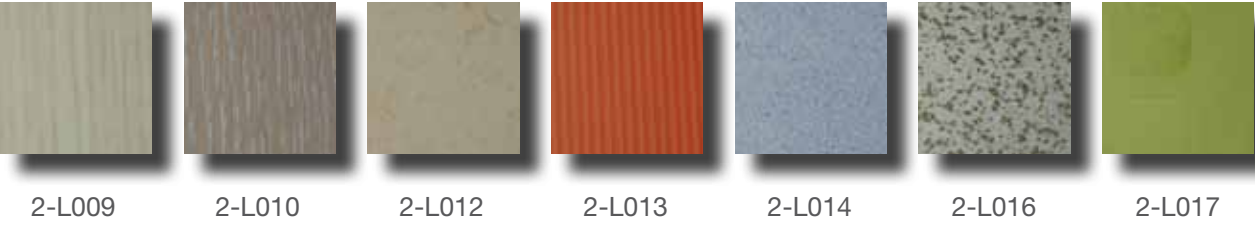

COLOURED GLASS

Available for: VARIO

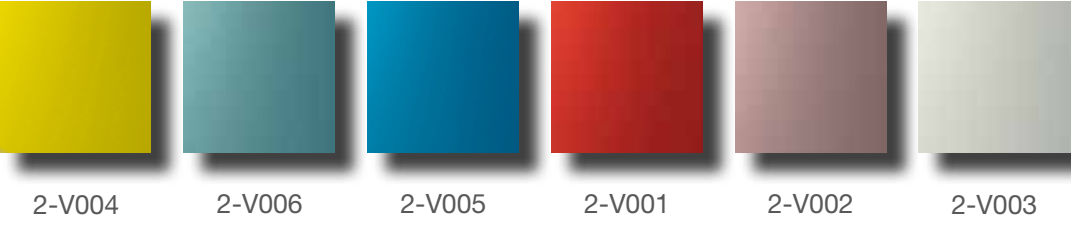

VENEERED WOOD

Available for: VARIO



MARBLE

Available for: VARIO



FINISHES

Floor

VARIOUS PVC

Available for: EASY - ADAPTA - CARGO - VARIO

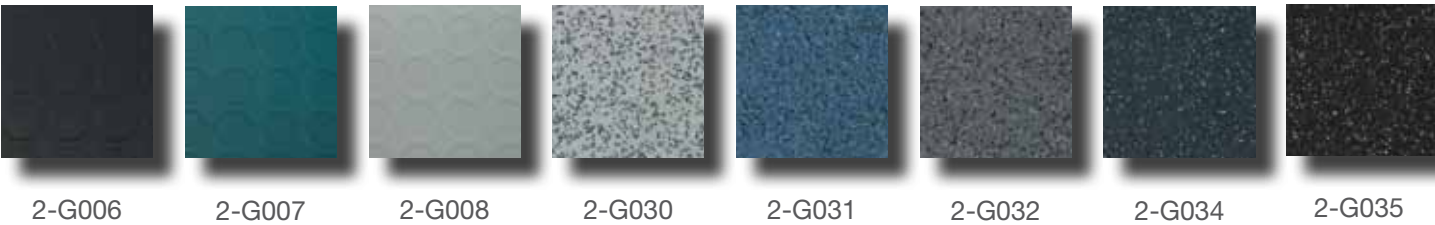
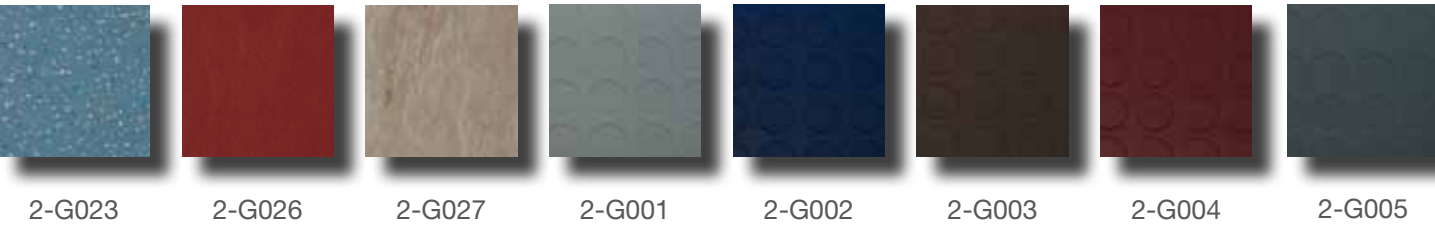
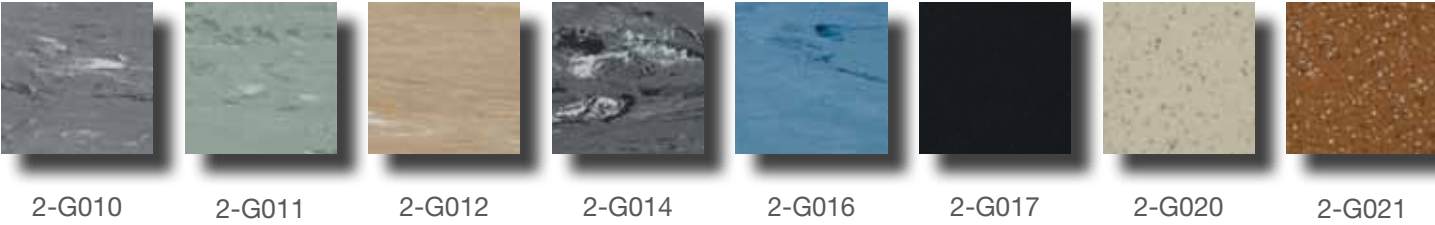

METAL

Available for: ADAPTA - CARGO - VARIO



COMPOSITE STONE

Available for: EASY - ADAPTA - VARIO

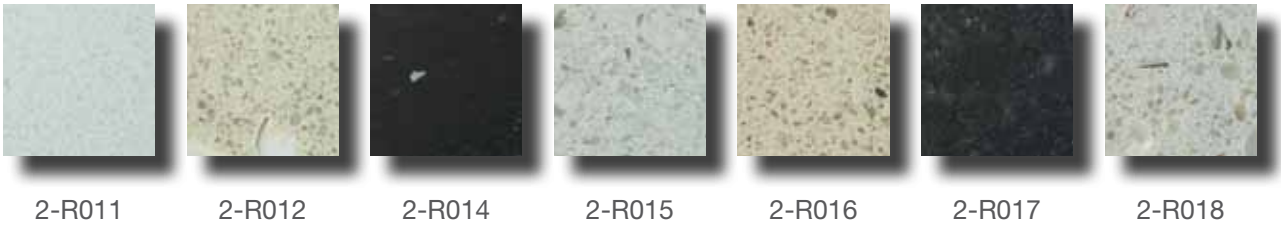

EMBEDDED

Available for: ADAPTA - CARGO - VARIO

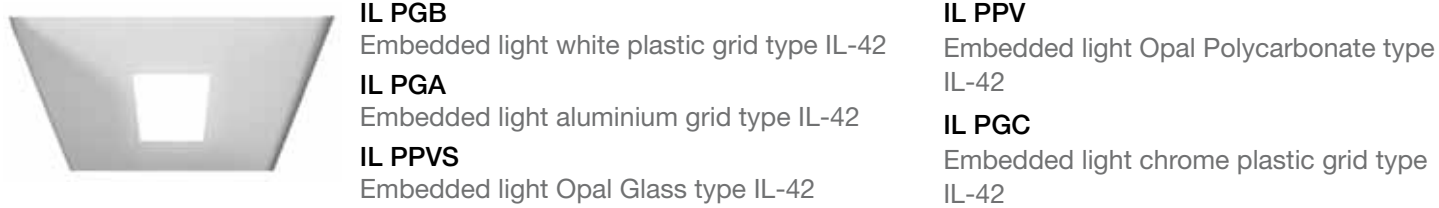

GLASS

Available for: EASY - ADAPTA - VARIO



SUSPENDED

Available for: EASY - ADAPTA - CARGO - VARIO



FINISHES

Handrails - Skirtings

HANDRAILS - ALUMINIUM

Available for: ADAPTA - CARGO - VARIO



HANDRAILS - STAINLESS STEEL

Available for: EASY - ADAPTA - CARGO - VARIO



FINISHES

Handrails - Skirtings

HANDRAILS - WOOD

Available for: ADAPTA - VARIO



SKIRTINGS - STAINLESS STEEL

Available for: EASY - ADAPTA - CARGO - VARIO

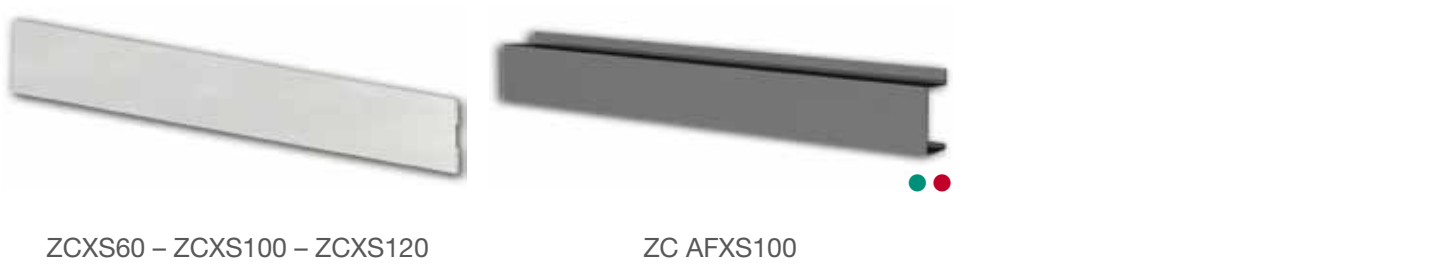

● Not available for CARGO

● Not available for EASY

FINISHES

Bumper Rails

WOOD

Available for: ADAPTA - CARGO - VARIO



PC L100

PC LX140

PVC

Available for: ADAPTA - CARGO - VARIO



PC G120

PC G75

PC G127

ALUMINUM

Available for: ADAPTA - CARGO - VARIO



PC A120

STAINLESS STEEL

Available for: ADAPTA - CARGO - VARIO



PC XS120

PC XRS150

FINISHES

Mirrors - Accessories

MIRRORS

Half wall, Full wall, Panels

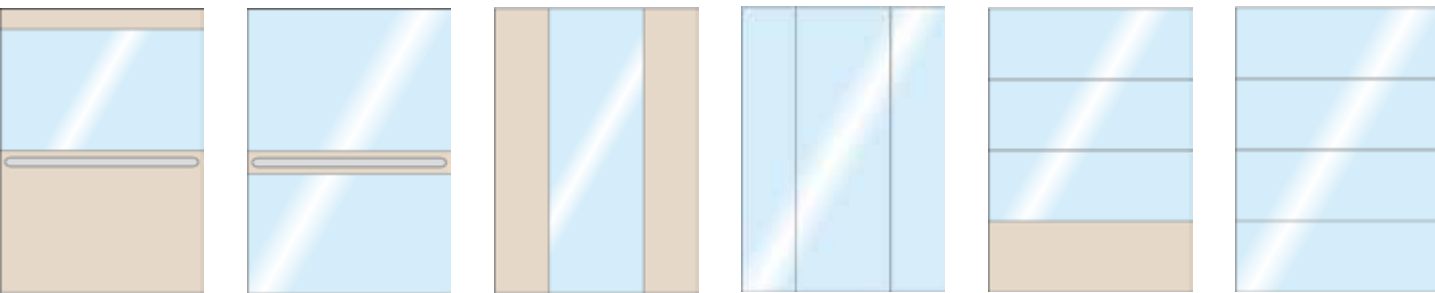

ACCESSORIES

Available for: ADAPTA - CARGO - VARIO

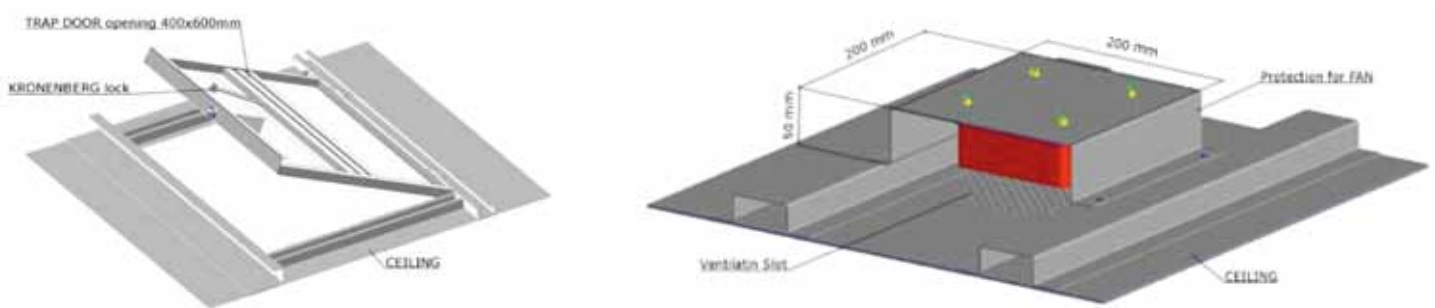

Trap door

Exhaust / Blowing fan

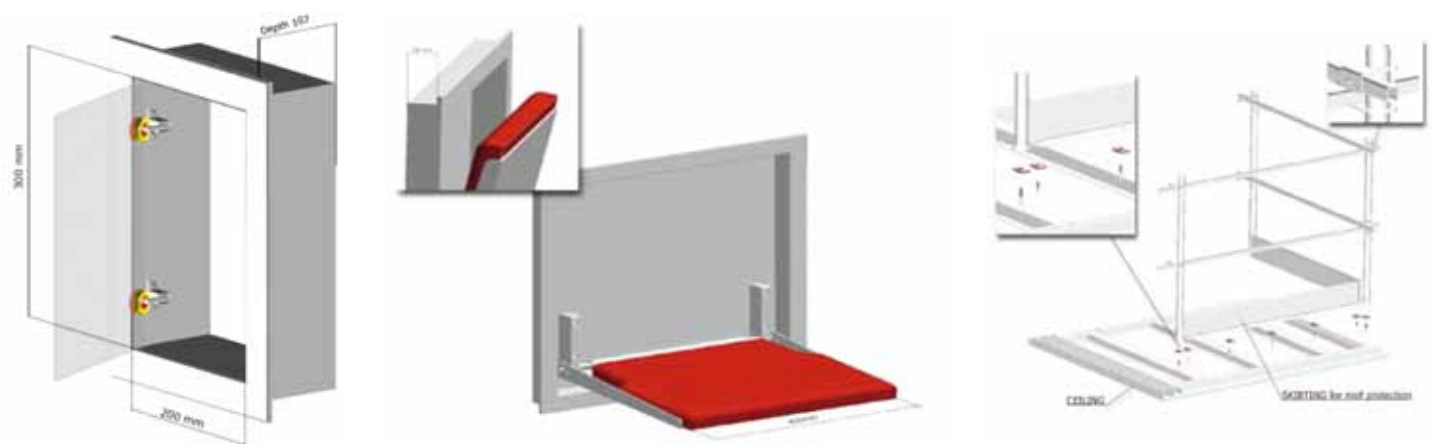

Telephone box

Folding seat

Car top railing

FINISHES

Selection Guide

| LEGENDA | | |
|---------|--------|--|
| E | EASY | |
| V | VARIO | |
| A | ADAPTA | |
| C | CARGO | |

| FLOOR FINISHES | | | | | |
|-----------------|--------|---|---|---|---|
| | CODE | E | V | A | C |
| Various | 2-G001 | ✓ | ✓ | ✓ | ✓ |
| | 2-G002 | ✓ | ✓ | ✓ | ✓ |
| | 2-G004 | ✓ | ✓ | ✓ | ✓ |
| | 2-G005 | ✓ | ✓ | ✓ | ✓ |
| | 2-G006 | ✓ | ✓ | ✓ | ✓ |
| | 2-G007 | ✓ | ✓ | ✓ | ✓ |
| | 2-G009 | ✓ | ✓ | ✓ | ✓ |
| | 2-G010 | ✓ | ✓ | ✓ | ✓ |
| | 2-G011 | ✓ | ✓ | ✓ | ✓ |
| | 2-G012 | ✓ | ✓ | ✓ | ✓ |
| | 2-G014 | ✓ | ✓ | ✓ | ✓ |
| | 2-G016 | ✓ | ✓ | ✓ | ✓ |
| | 2-G017 | ✓ | ✓ | ✓ | ✓ |
| | 2-G019 | ✓ | ✓ | ✓ | ✓ |
| | 2-G020 | ✓ | ✓ | ✓ | ✓ |
| | 2-G021 | ✓ | ✓ | ✓ | ✓ |
| | 2-G023 | ✓ | ✓ | ✓ | ✓ |
| | 2-G026 | ✓ | ✓ | ✓ | ✓ |
| | 2-G027 | ✓ | ✓ | ✓ | ✓ |
| | 2-G030 | ✓ | ✓ | ✓ | ✓ |
| | 2-G031 | ✓ | ✓ | ✓ | ✓ |
| Metal | 2-G024 | ✗ | ✓ | ✓ | ✓ |
| | 2-G025 | ✗ | ✓ | ✓ | ✓ |
| | 2-G029 | ✗ | ✓ | ✓ | ✓ |
| | 2-R011 | ✓ | ✓ | ✓ | ✗ |
| Composite stone | 2-R012 | ✓ | ✓ | ✓ | ✗ |
| | 2-R013 | ✓ | ✓ | ✓ | ✗ |
| | 2-R014 | ✓ | ✓ | ✓ | ✗ |
| | 2-R015 | ✓ | ✓ | ✓ | ✗ |
| | 2-R016 | ✓ | ✓ | ✓ | ✗ |
| | 2-R017 | ✓ | ✓ | ✓ | ✗ |
| | 2-R018 | ✓ | ✓ | ✓ | ✗ |

| WALL FINISHES | | | | | |
|------------------|--------|---|---|---|---|
| | CODE | E | V | A | C |
| Skinplate | 2-K001 | ✓ | ✗ | ✓ | ✓ |
| | 2-K010 | ✓ | ✗ | ✓ | ✓ |
| | 2-K011 | ✓ | ✗ | ✓ | ✓ |
| | 2-K012 | ✓ | ✗ | ✓ | ✓ |
| | 2-K013 | ✓ | ✗ | ✓ | ✓ |
| | 2-K014 | ✓ | ✗ | ✓ | ✓ |
| | 2-K015 | ✓ | ✗ | ✓ | ✓ |
| | 2-K016 | ✓ | ✗ | ✓ | ✓ |
| | 2-K017 | ✓ | ✗ | ✓ | ✓ |
| | 2-K018 | ✓ | ✗ | ✓ | ✓ |
| | 2-K002 | ✓ | ✗ | ✓ | ✓ |
| | 2-K003 | ✓ | ✗ | ✓ | ✓ |
| | 2-K004 | ✓ | ✗ | ✓ | ✓ |
| | 2-K005 | ✓ | ✗ | ✓ | ✓ |
| | 2-K006 | ✓ | ✗ | ✓ | ✓ |
| | 2-K007 | ✓ | ✗ | ✓ | ✓ |
| | 2-K008 | ✓ | ✗ | ✓ | ✓ |
| | 2-K009 | ✓ | ✗ | ✓ | ✓ |
| | 2-K019 | ✓ | ✗ | ✓ | ✓ |
| Panoprey | 2-P001 | ✓ | ✓ | ✗ | ✗ |
| | 2-P002 | ✓ | ✓ | ✗ | ✗ |
| | 2-P003 | ✓ | ✓ | ✗ | ✗ |
| | 2-P004 | ✓ | ✓ | ✗ | ✗ |
| | 2-P005 | ✓ | ✓ | ✗ | ✗ |
| | 2-P006 | ✓ | ✓ | ✗ | ✗ |
| | 2-P007 | ✓ | ✓ | ✗ | ✗ |
| | 2-P008 | ✓ | ✓ | ✗ | ✗ |
| | 2-P009 | ✓ | ✓ | ✗ | ✗ |
| Plastic Laminate | 2-L009 | ✓ | ✓ | ✗ | ✗ |
| | 2-L010 | ✓ | ✓ | ✗ | ✗ |
| | 2-L012 | ✓ | ✓ | ✗ | ✗ |
| | 2-L013 | ✓ | ✓ | ✗ | ✗ |
| | 2-L014 | ✓ | ✓ | ✗ | ✗ |
| Marble | 2-M001 | ✗ | ✓ | ✗ | ✗ |
| | 2-M002 | ✗ | ✓ | ✗ | ✗ |
| | 2-M003 | ✗ | ✓ | ✗ | ✗ |
| | 2-M004 | ✗ | ✓ | ✗ | ✗ |
| Wood | 2-W001 | ✗ | ✓ | ✗ | ✗ |
| | 2-W002 | ✗ | ✓ | ✗ | ✗ |
| | 2-W003 | ✗ | ✓ | ✗ | ✗ |
| | 2-W004 | ✗ | ✓ | ✗ | ✗ |

| WALL FINISHES | | | | | |
|---------------------------|----------|---|---|---|---|
| | CODE | E | V | A | C |
| Wood | 2-W005 | ✗ | ✓ | ✗ | ✗ |
| | 2-W006 | ✗ | ✓ | ✗ | ✗ |
| Colored glass | 2-V001 | ✗ | ✓ | ✗ | ✗ |
| | 2-V002 | ✗ | ✓ | ✗ | ✗ |
| | 2-V003 | ✗ | ✓ | ✗ | ✗ |
| | 2-V004 | ✗ | ✓ | ✗ | ✗ |
| | 2-V005 | ✗ | ✓ | ✗ | ✗ |
| | 2-V006 | ✗ | ✓ | ✗ | ✗ |
| Painted Steel | RAL 5017 | ✓ | ✗ | ✓ | ✓ |
| | RAL 7035 | ✓ | ✗ | ✓ | ✓ |
| | RAL 9006 | ✓ | ✗ | ✓ | ✓ |
| | RAL 9007 | ✓ | ✗ | ✓ | ✓ |
| | RAL 9010 | ✓ | ✗ | ✓ | ✓ |
| | RAL 3003 | ✓ | ✗ | ✓ | ✓ |
| | RAL 2003 | ✓ | ✗ | ✓ | ✓ |
| | RAL 5022 | ✓ | ✗ | ✓ | ✓ |
| | RAL 7016 | ✓ | ✗ | ✓ | ✓ |
| | RAL 1013 | ✓ | ✗ | ✓ | ✓ |
| Stainless Steel (St. st.) | RAL 7021 | ✓ | ✗ | ✓ | ✓ |
| | RAL 1014 | ✓ | ✗ | ✓ | ✓ |
| | 2-S001 | ✓ | ✓ | ✓ | ✓ |
| | 2-S002 | ✓ | ✓ | ✓ | ✓ |
| | 2-S003 | ✓ | ✓ | ✓ | ✓ |
| | 2-S004 | ✓ | ✓ | ✓ | ✓ |
| | 2-S005 | ✓ | ✓ | ✓ | ✓ |
| | 2-S006 | ✓ | ✓ | ✓ | ✓ |
| | 2-S007 | ✓ | ✓ | ✓ | ✓ |
| | 2-S008 | ✓ | ✓ | ✓ | ✓ |
| | 2-S009 | ✓ | ✓ | ✓ | ✓ |
| | 2-S010 | ✓ | ✓ | ✓ | ✓ |
| | 2-S011 | ✓ | ✓ | ✓ | ✓ |
| | 2-S012 | ✓ | ✓ | ✓ | ✓ |
| | 2-S013 | ✓ | ✓ | ✓ | ✓ |
| | 2-S014 | ✓ | ✓ | ✓ | ✓ |
| | 2-S015 | ✓ | ✓ | ✓ | ✓ |
| | 2-S016 | ✓ | ✓ | ✓ | ✓ |
| | 2-S017 | ✓ | ✓ | ✓ | ✓ |
| | 2-S018 | ✓ | ✓ | ✓ | ✓ |
| | 2-S019 | ✓ | ✓ | ✓ | ✓ |
| | 2-S021 | ✓ | ✓ | ✓ | ✓ |
| | 2-S024 | ✓ | ✓ | ✓ | ✓ |
| | 2-S029 | ✓ | ✓ | ✓ | ✓ |

FINISHES

Selection Guide

| CEILING FINISHES | | | | | |
|------------------|------------|---|---|---|---|
| | CODE | E | V | A | C |
| Glass | IL 221 | ✓ | ✓ | ✓ | ✗ |
| | IL 222 | ✓ | ✓ | ✓ | ✗ |
| Embedded | IL-42 PPV | ✗ | ✓ | ✓ | ✓ |
| | IL-42 PGB | ✗ | ✓ | ✓ | ✓ |
| | IL-42 PGC | ✗ | ✓ | ✓ | ✓ |
| | IL-42 PGA | ✗ | ✓ | ✓ | ✓ |
| | IL-42 PPVS | ✗ | ✓ | ✓ | ✓ |
| | IL-42 PGB | ✗ | ✓ | ✓ | ✓ |
| Suspended | IL 200 | ✓ | ✓ | ✓ | ✓ |
| | IL 201 | ✓ | ✓ | ✓ | ✓ |
| | IL 203 | ✓ | ✓ | ✓ | ✓ |
| | IL 204 | ✓ | ✓ | ✓ | ✓ |
| | IL 205 | ✗ | ✓ | ✓ | ✓ |
| | IL 206 | ✗ | ✓ | ✓ | ✓ |
| | IL 207 | ✗ | ✓ | ✓ | ✗ |
| | IL 208 | ✗ | ✓ | ✓ | ✗ |
| | IL 209 | ✗ | ✓ | ✓ | ✗ |
| | IL 210 | ✓ | ✓ | ✓ | ✗ |
| | IL 211 | ✗ | ✓ | ✓ | ✗ |
| | IL 212 | ✗ | ✓ | ✓ | ✗ |
| | IL 213 | ✗ | ✓ | ✓ | ✗ |
| | IL 215 | ✗ | ✓ | ✓ | ✗ |
| | IL 216 | ✗ | ✓ | ✓ | ✗ |
| | IL 217 | ✗ | ✓ | ✓ | ✗ |
| | IL 218 | ✗ | ✓ | ✓ | ✗ |
| | IL 219 | ✗ | ✓ | ✓ | ✗ |

| BUMPER RAILS | | | | | |
|--------------|-----------|---|---|---|---|
| | CODE | E | V | A | C |
| Wood | PC L100 | ✗ | ✓ | ✓ | ✓ |
| | PC LX140 | ✗ | ✓ | ✓ | ✓ |
| PVC | PC G120 | ✗ | ✓ | ✓ | ✓ |
| | PC G75 | ✗ | ✓ | ✓ | ✓ |
| | PC P127 | ✗ | ✓ | ✓ | ✓ |
| | PC A120 | ✗ | ✓ | ✓ | ✓ |
| Alu | PC XS120 | ✗ | ✓ | ✓ | ✓ |
| | PC XRS150 | ✗ | ✓ | ✓ | ✓ |
| St.st. | PC XS120 | ✗ | ✓ | ✓ | ✓ |
| | PC XRS150 | ✗ | ✓ | ✓ | ✓ |

| HANDRAILS | | | | | |
|---------------------------|------------|---|---|---|---|
| | CODE | E | V | A | C |
| Aluminium | CO A60-8 | ✗ | ✓ | ✓ | ✓ |
| | CO A120-8 | ✗ | ✓ | ✓ | ✓ |
| | CO A60P | ✗ | ✓ | ✓ | ✓ |
| | CO A120P | ✗ | ✓ | ✓ | ✓ |
| | CO A40-E | ✗ | ✓ | ✓ | ✓ |
| | CO A40-I | ✗ | ✓ | ✓ | ✓ |
| Stainless Steel (St. st.) | CO X40I | ✓ | ✓ | ✓ | ✓ |
| | CO X28I | ✓ | ✓ | ✓ | ✓ |
| | CO X40E | ✓ | ✓ | ✓ | ✓ |
| | CO X28E | ✓ | ✓ | ✓ | ✓ |
| | CO X40L | ✓ | ✓ | ✓ | ✓ |
| | CO X28L | ✓ | ✓ | ✓ | ✓ |
| | CO X40IC | ✓ | ✓ | ✓ | ✓ |
| | CO X40EC | ✓ | ✓ | ✓ | ✓ |
| | CO X28IC | ✓ | ✓ | ✓ | ✓ |
| | CO X28EC | ✓ | ✓ | ✓ | ✓ |
| | CO X40LC | ✓ | ✓ | ✓ | ✓ |
| | CO X28LC | ✓ | ✓ | ✓ | ✓ |
| Wood | CO X60-2 | ✗ | ✓ | ✓ | ✓ |
| | CO X40ICC | ✗ | ✓ | ✓ | ✓ |
| | CO L40I | ✗ | ✓ | ✓ | ✗ |
| | CO L40E | ✗ | ✓ | ✓ | ✗ |
| | CO L40L | ✗ | ✓ | ✓ | ✗ |
| | CO L40IC | ✗ | ✓ | ✓ | ✗ |
| | CO L40EC | ✗ | ✓ | ✓ | ✗ |
| | CO L40LC | ✗ | ✓ | ✓ | ✗ |
| Stainless Steel | CO F1002 | ✗ | ✓ | ✓ | ✗ |
| | CO L40ICC | ✗ | ✓ | ✓ | ✗ |
| | ZC XS60 | ✓ | ✓ | ✓ | ✓ |
| | ZC XS100 | ✓ | ✓ | ✓ | ✓ |
| | ZC XS120 | ✓ | ✓ | ✓ | ✓ |
| | ZC AFXS100 | ✗ | ✓ | ✓ | ✗ |
| | ZC AFXD100 | ✗ | ✓ | ✓ | ✗ |





www.sematic.com

Italy

Sematic Spa - Group Headquarters

Via Zappa Comm. Francesco, 5
24046 Osio Sotto, Bergamo
Tel. +39 035 48 15 100 - Fax +39 035 48 15 199
e-mail info@sematic.com

Sematic Spa- Suisio Plant

Via dei Piazzoli, 1/5
24040 Suisio, Bergamo
Tel. +39 035 49 36 111 - Fax. +39 035 90 24 51
e-mail info@sematic.com

United Kingdom

Sematic UK Ltd

Meadow Gate, Valley Park Est.
Wombwell, Barnsley, South Yorkshire S73 0UN
Tel. +44 1226 344 800 - Fax. +44 1226 344 811
e-mail info@uk.sematic.com

Turkey

Sematic Asansör San.ve Tic.Ltd.Sti.

Necip Fazıl Bulvarı Keyap Çarşı Sitesi F2 Blok No.99
Yukarıdudullu / Ümraniye, 34775 İstanbul
Tel. +90 216 508 1470 (PBX) - Fax +90 216 508 1473
e-mail info@tr.sematic.com

Hungary

Sematic Hungária Kft

Debreceni út 273
4400 Nyíregyháza
Tel. +36 42 548 410 - Fax +36 42 548 419
e-mail info@hu.sematic.com

Singapore

Sematic Singapore Pte Ltd

8 Burn Road, 1301 Trivex
369977 Singapore
e-mail info@sg.sematic.com

China

Sematic Elevator Products (Suzhou) Co., Ltd

215121, No. 52 Weixi Road, Weiting Science Park
Suzhou Industrial Park
Tel. +86 512 8717 1819 - Fax +86 512 8717 1820
e-mail info@cn.sematic.com

Sematic Elevator Products (Changshu) Co.,Ltd.

215558, No 18 Jinmen Load Changshu Southeast
Economic Development Zone of Jiangsu
Tel. + 86 512 8717 1819 - Fax +86 512 8717 1820
e-mail info@cn.sematic.com

Sematic (Hong Kong) Ltd

Unit 1807, Mindas Plaza, No. 1 Tai Yau Street,
San Po Kong, Kowloon, Hong Kong
Tel. +852 219 47 166 - Fax +852 219 47 322
e-mail info@hk.sematic.com

India

Sematic RE Elevator Products (India) Pvt. Ltd

Madhuban, F-Wing, 1st Floor, W.E. Highway, Near Dahisar
Telephone Exchange, Dahisar (E), Mumbai 400068
Tel. +91 022 2897 2184 / 3184 - Fax +91 022 2897 8643
e-mail info@in.sematic.com

Mexico

Sematic Elevadores Mexico S. de R.L. de C.V.

Bldv Revolucion Mexicana n°1001 Col Barrera,
Monclova, Coahuila 25770
Tel. +52 (866) 648 3365 / 66 / 67 - Fax (ext 160)
e-mail info@tyler.sematic.com

USA

Tyler Elevator Products Div. of Sematic USA Inc.

7852, Bavaria Road
Twinsburg, Ohio 44087
Tel. +1 216 524 0100 - Fax. +1 216 524 9710
e-mail info@tyler.sematic.com